

COMPLETE
COLLECTION

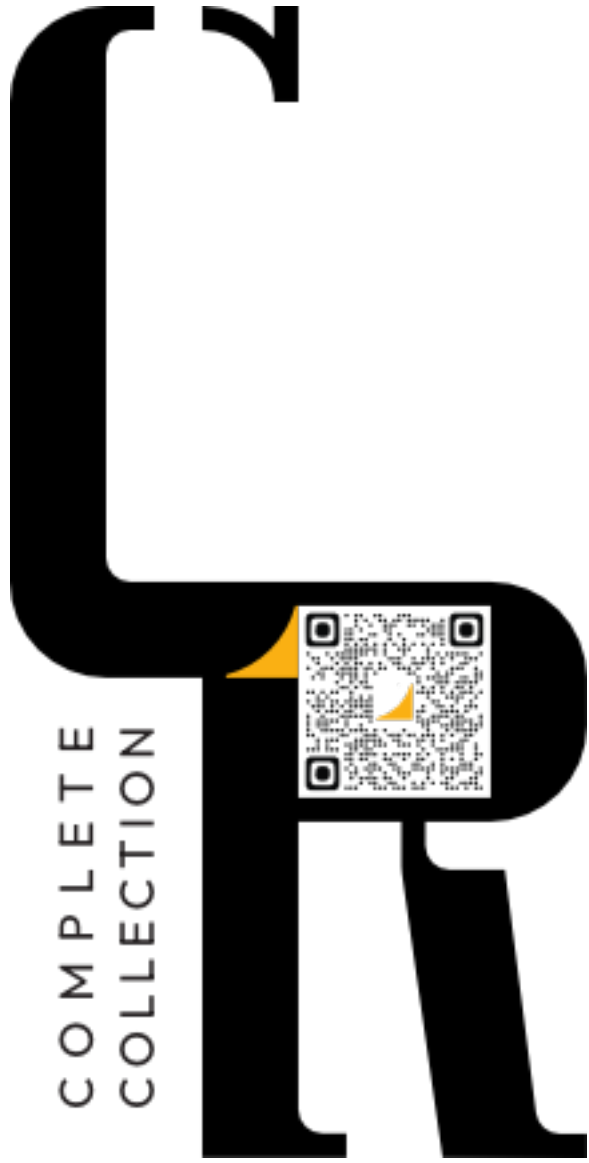

Introduction

Hello! I'm Carlos Romero. A graduate from the Bachelor of Interior Design program at Algonquin College, and a working designer.

I am drawn to design that is influenced or driven by nature, art, and technology. I'm especially drawn to creating spaces that promote community and connection for meaningful interactions within the space.

Throughout my design career, I aim to explore opportunities across multiple design disciplines. Including residential, commercial, furniture, millwork, exhibition, retail, and experiential design to continuously expand my knowledge and creative perspective.

Skills

- Hand drawing and rendering.
- Modelling skills in SketchUp & Layout, AutoCAD, Revit.
- Creative skills in programs like photo editing, vectors, and layout creations. Software include Adobe photoshop & Illustrator, as well as Affinity by Canva.
- Office skills such as word processing, spreadsheets, and presentation programs.

Work Experience & Education

- Designer at Stairline Railings
- Independent Designer & Painter
- Bachelor of Interior Design, Honours (Degree)
- Design Studies (Certificate)

Certifications

- **Intern, ARIDO**
Association of Registered Interior Designers of Ontario
- **Construction 101 & Beyond**
Ottawa Construction Association
- **Building Biology Advocate**
Building Biology Institute

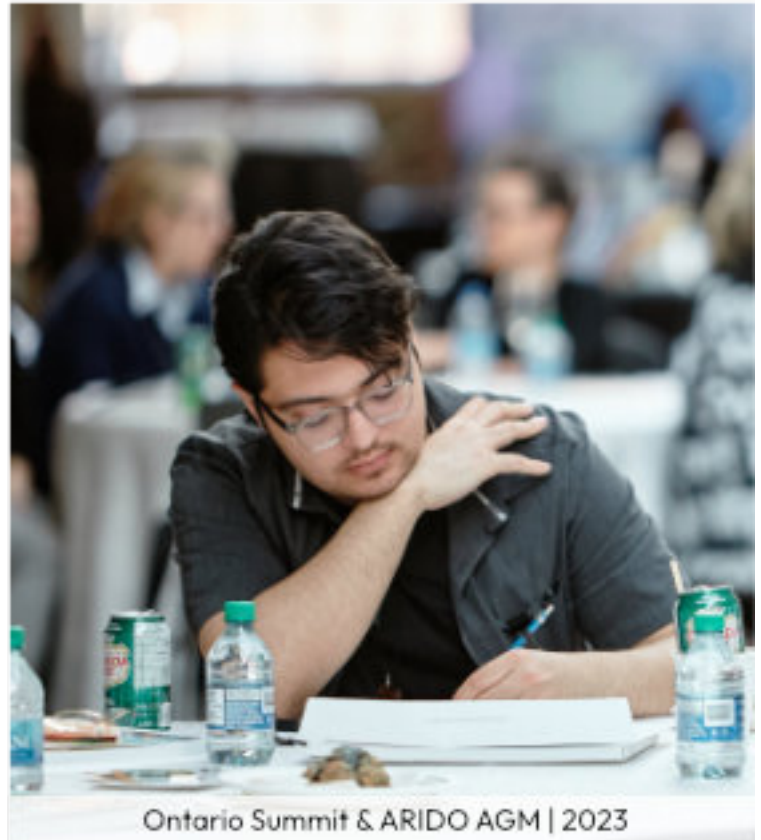

Ontario Summit & ARIDO AGM | 2023



Relevant Activities

- **Summit Entrepreneurship Bootcamp**
Participant in a 1-week competition to develop a business idea and pitch the final concept to a panel of judges
- **Culture in Design**
Participant in the Ontario Summit & ARIDO AGM
- **World Design Challenge**
Team member in an international and interdisciplinary design competition with Algonquin College, UPES University, and the World Design Organization (WDO).
- **Ottawa Design Club & Concept Carleton**
Attendee

Table of Contents

- 1 Mural: Caterpillar's Journey**
Healthcare
- 5 Simplifying the Move**
Residential Design
- 9 Dual Gamers**
Residential Design
- 13 Stair Design Showcase**
Residential/Commercial Design
- 17 Deck Design (2024)**
Residential Design
- 21 Leone's K9-5: Doggy Daycare**
Commercial/Hospitality Design
- 25 Deck Design (2023)**
Residential Design
- 29 S.T.E.A.M. Makerspace Library**
Institutional Design
- 33 Provecho**
Hospitality Design
- 37 Deck Design (2022)**
Residential Design
- 41 Cultural Association for Healthy Minds**
Healthcare Design
- 45 Cuppedia**
Commercial/ Residential Design

Mural: Caterpillar's Journey

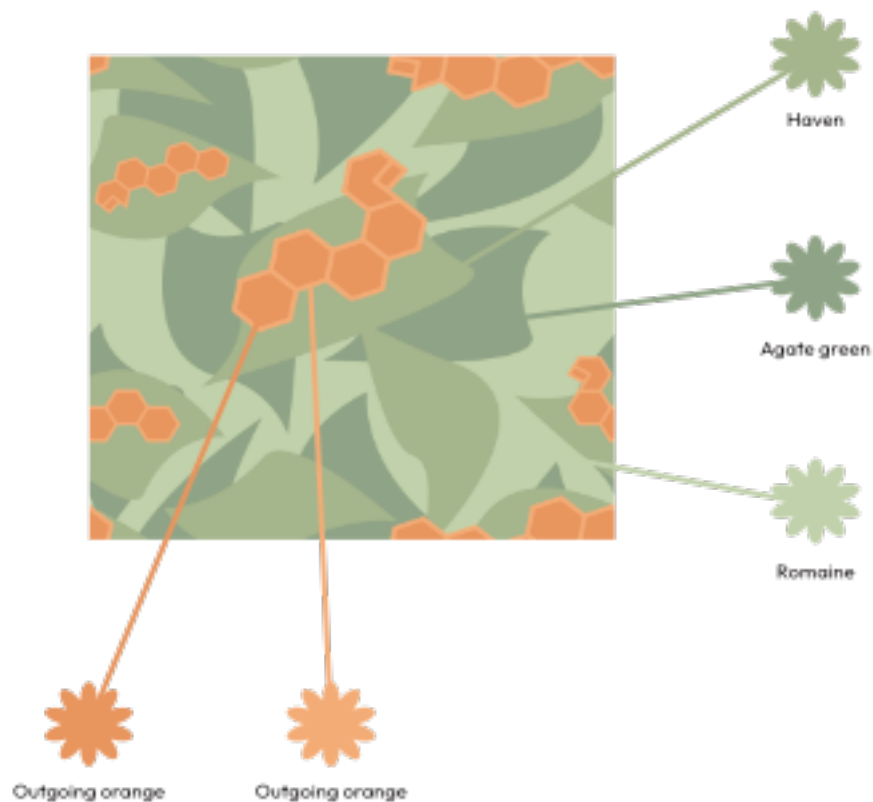

Independent Painting Healthcare

- The space was modelled in Sketchup following the site visit
- Ideation through hand sketching
- Concepts were refined using vector software and imported to scale into sketchup to produce accurate visualizations
- Concept presentation sheets were created and presented to the clients
- Icons were also created to identify offices and bedrooms. Trees are for the offices because they symbolise a collective wisdom and support. All other symbols represent the individual.
- Both the mural and icons are inspired by natural elements and colours



CRAWLING

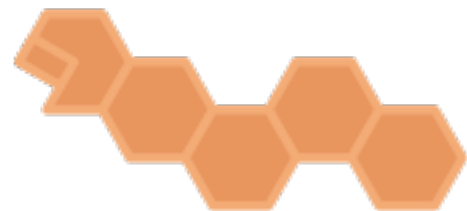









REACHING/EATING



STANDING

Mural: Caterpillar's Journey



			ICONS FOR OFFICES
			
			

Mural: Caterpillar's Journey



BEFORE



PLOTTING

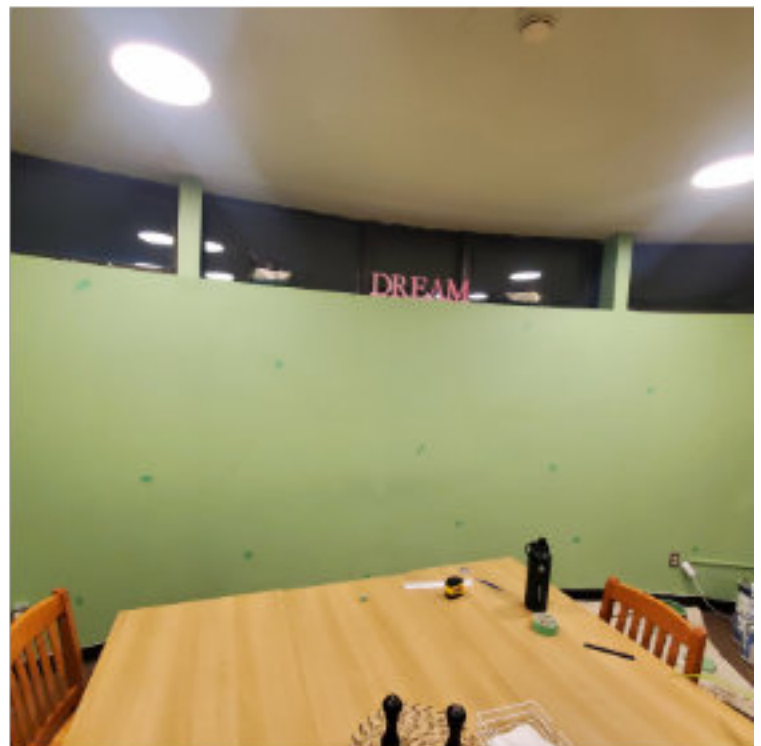

Mural: Caterpillar's Journey



Simplifying the Move



RENDER: KITCHEN

Independent Design Residential Design

- The new residents were looking for renders to visualize key furniture items in their new place
- One of the new roommates was downsizing from their previous place while the second was bringing minimal items for their bedroom.
- Floor plan layouts and renders were provided to help them explore ideas and gain confidence with the move.
- 6 months later, the design stays true to the original intent with personal touches that they have added.

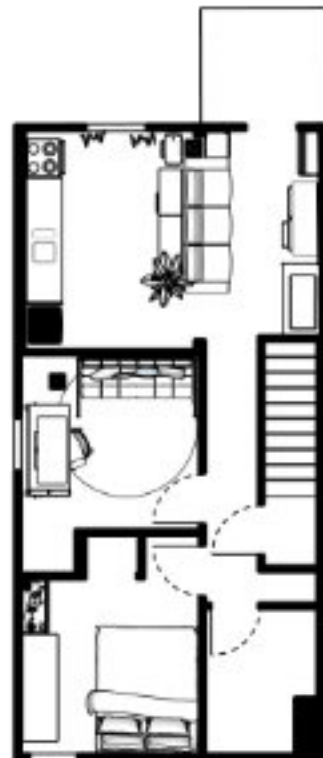

Simplifying the Move



ISOMETRIC SECTION



RENDER: LIVING ROOM

Simplifying the Move



6 MONTHS AFTER MOVE-IN

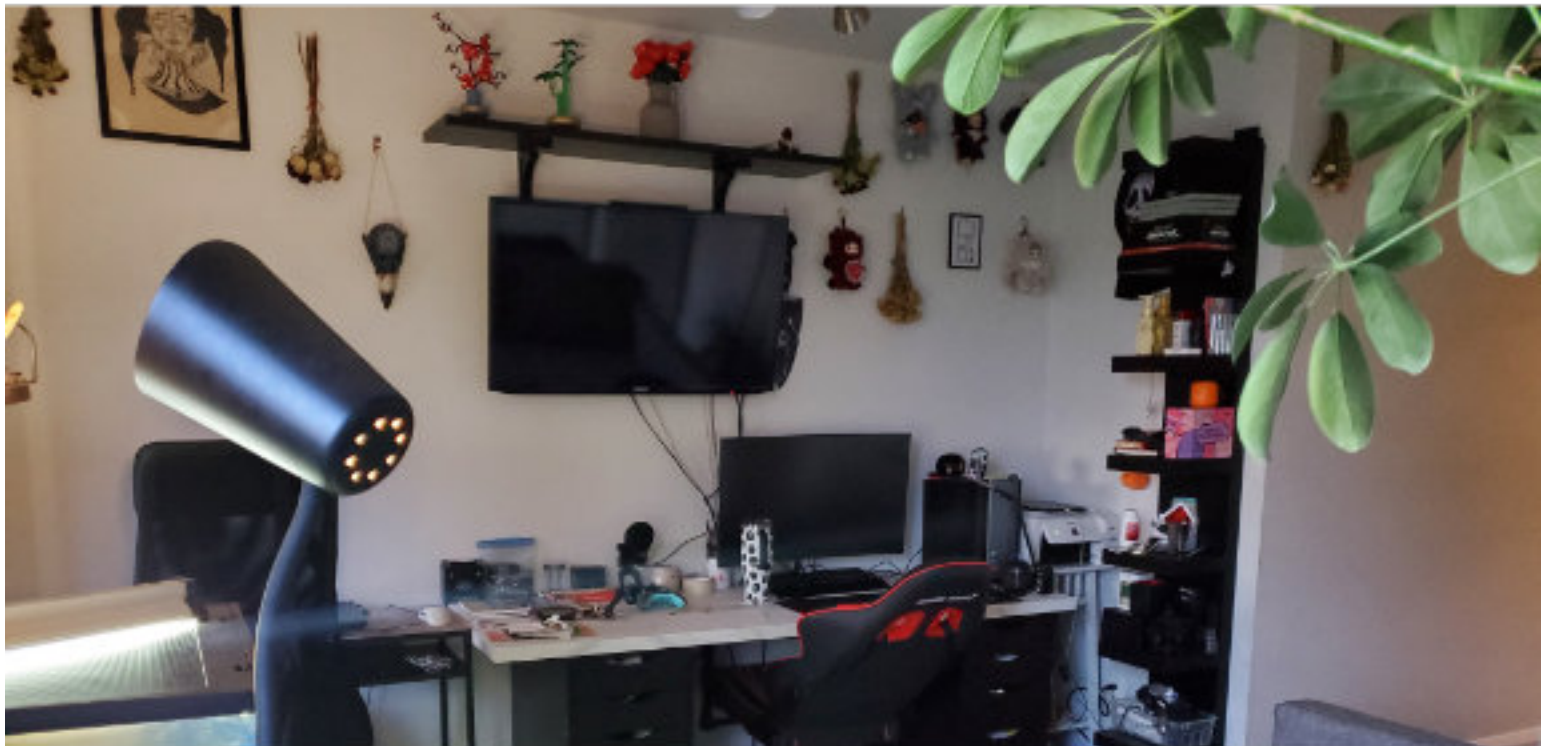

6 MONTHS AFTER MOVE-IN

Simplifying the Move

Simplifying the Move



6 MONTHS AFTER MOVE-IN



6 MONTHS AFTER MOVE-IN

Dual Gamers



Independent Design Residential Design

- The project focuses on optimizing the space to be shared by two avid gamers.
- Design challenges included effectively accommodating two large gaming setups.
- Key considerations included acoustics and visual privacy.
- Secondary to the main project was conceptual ideas for the large bathroom to explore ideas on how to maximize the space

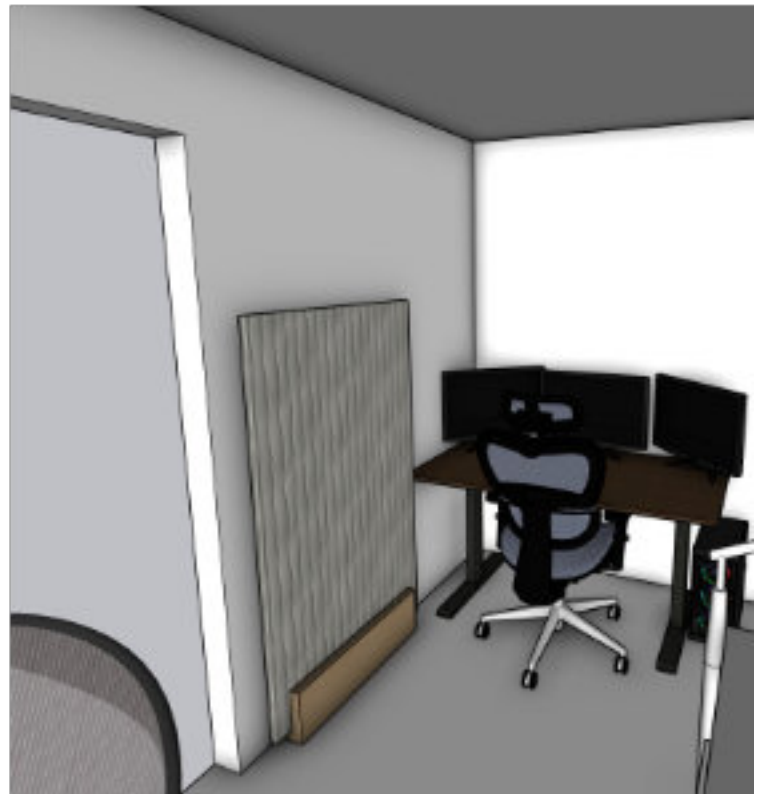

Dual Gamers

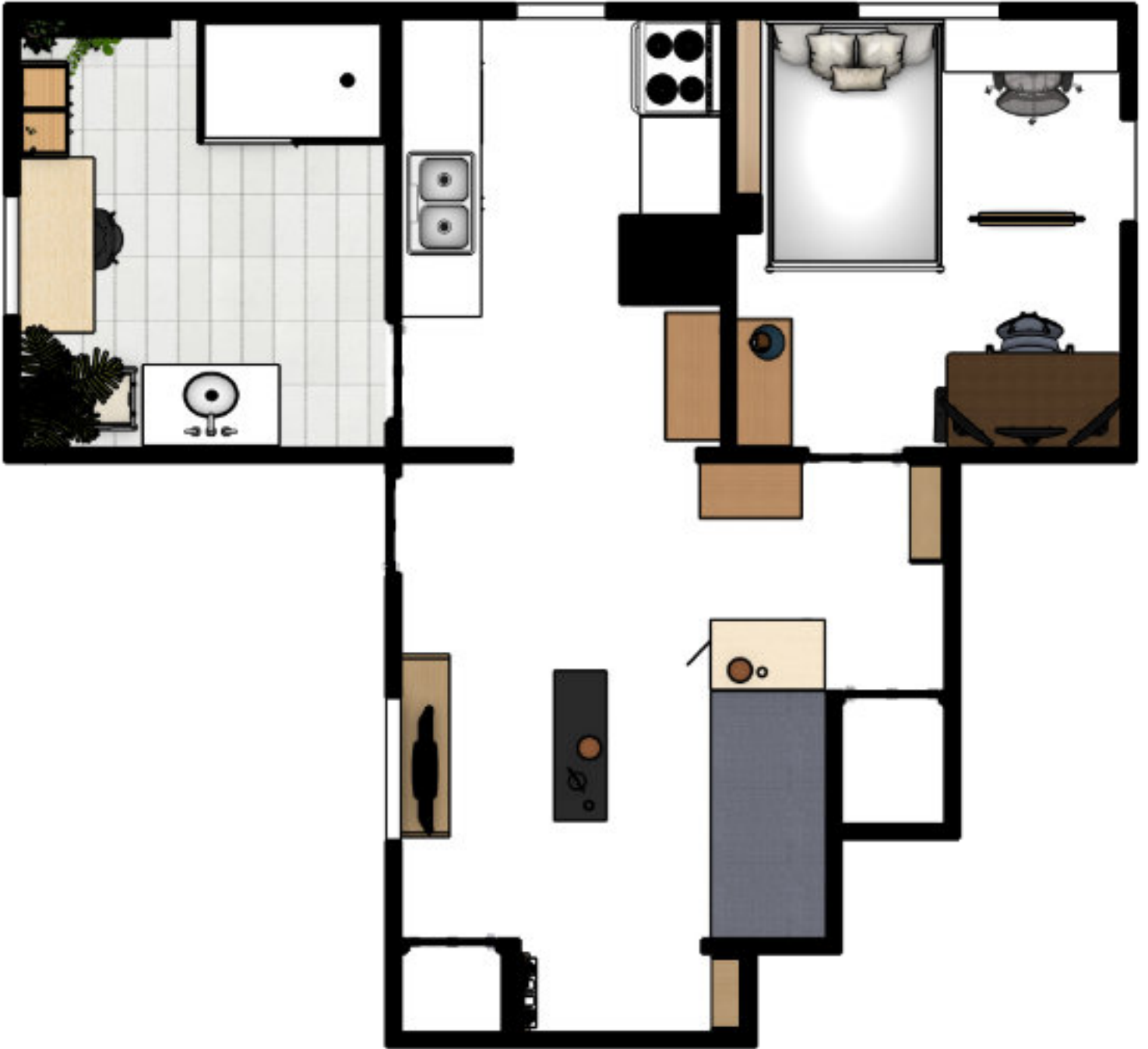

Dual Gamers

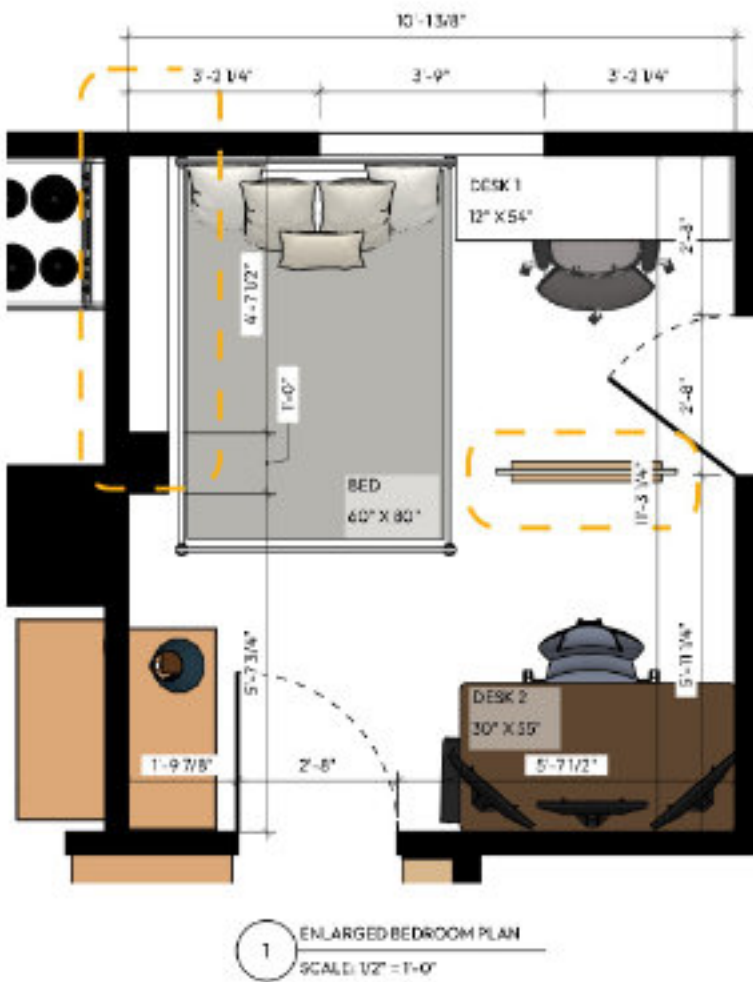

INSPIRATION

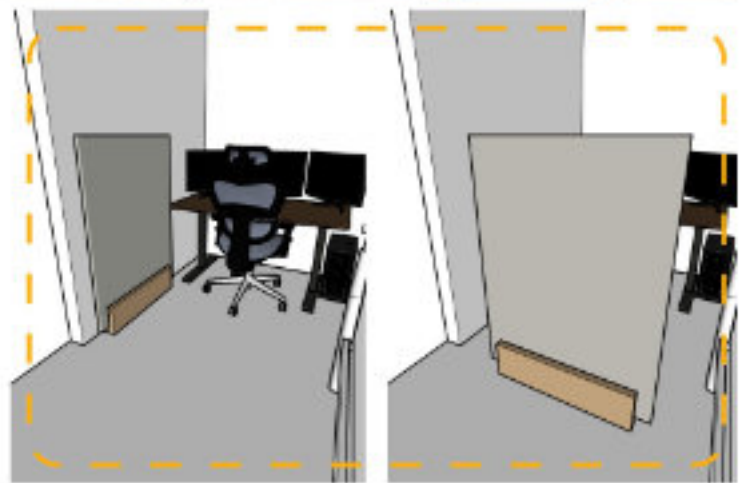

Dual Gamers

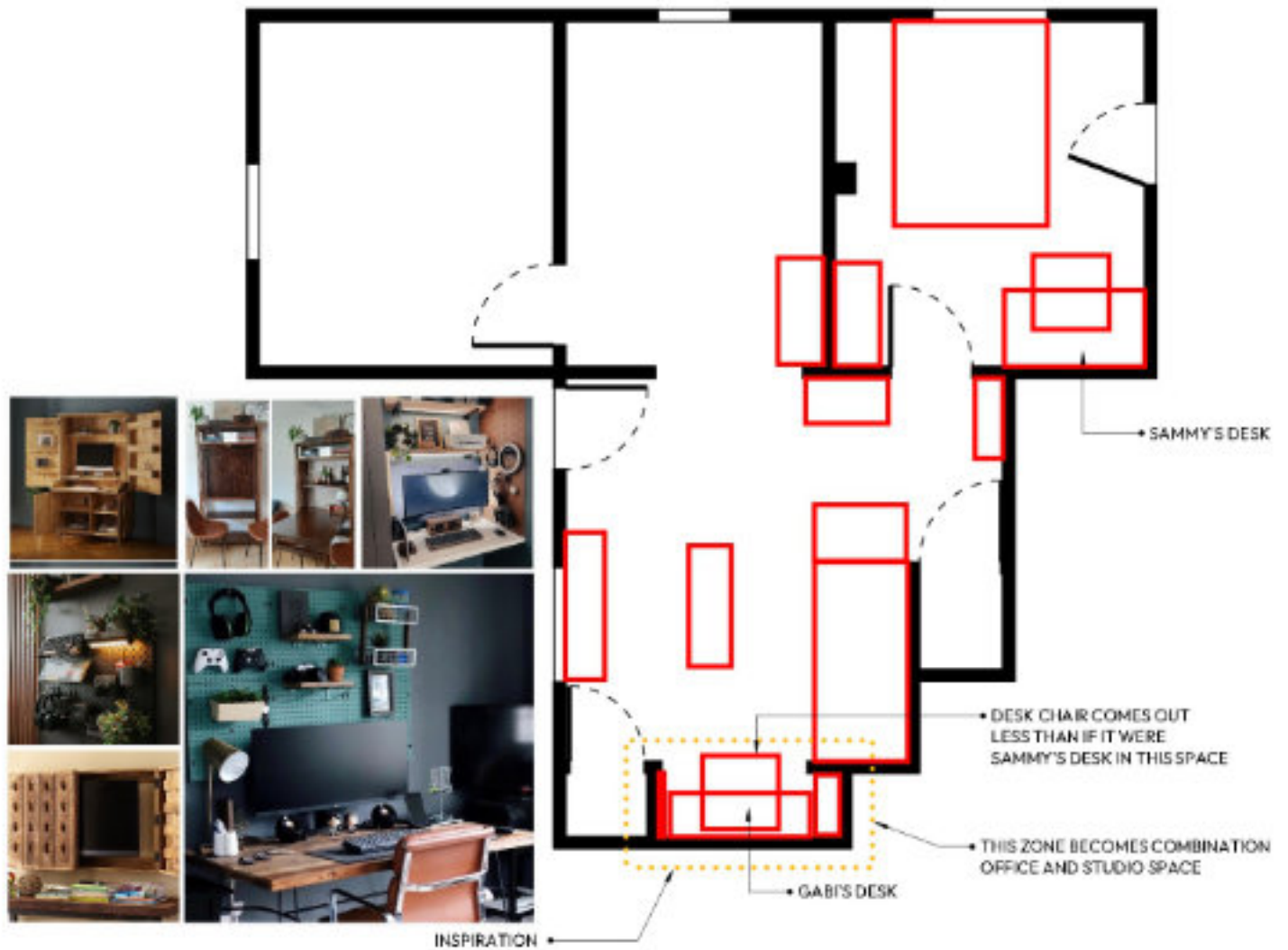

Stair Design Showcase



Stairline Railings Residential/Commercial Design

- Designed various stair and railing styles from solid wood construction to glass and metal
- Priced projects and prepared quotes
- Created 3D models and customer presentation sheets
- Produced shop drawings for in-house carpenters and other trades
- Collaborated with lead carpenter, general contractors, architects, and designers on complex and large scale builds
- Identified fabrication details early to ensure smooth production and installation

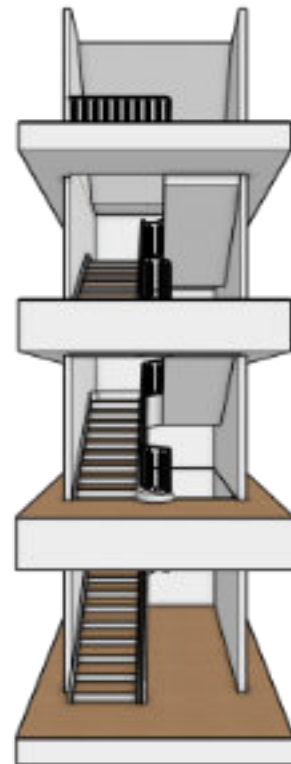

Stair Design Showcase

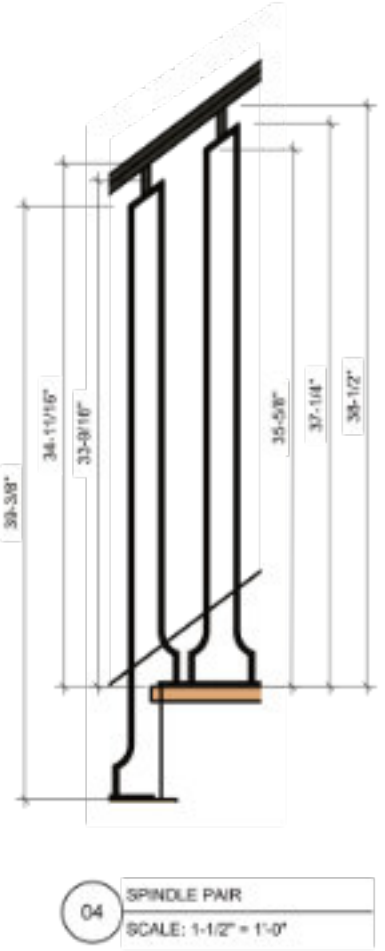
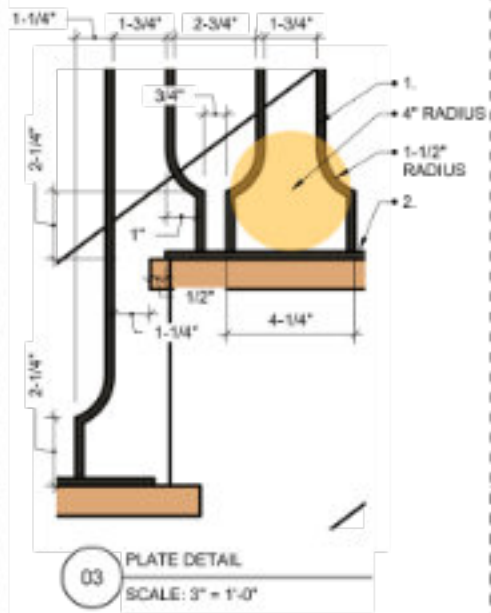
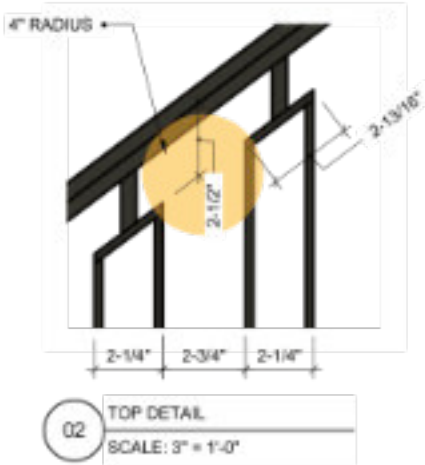
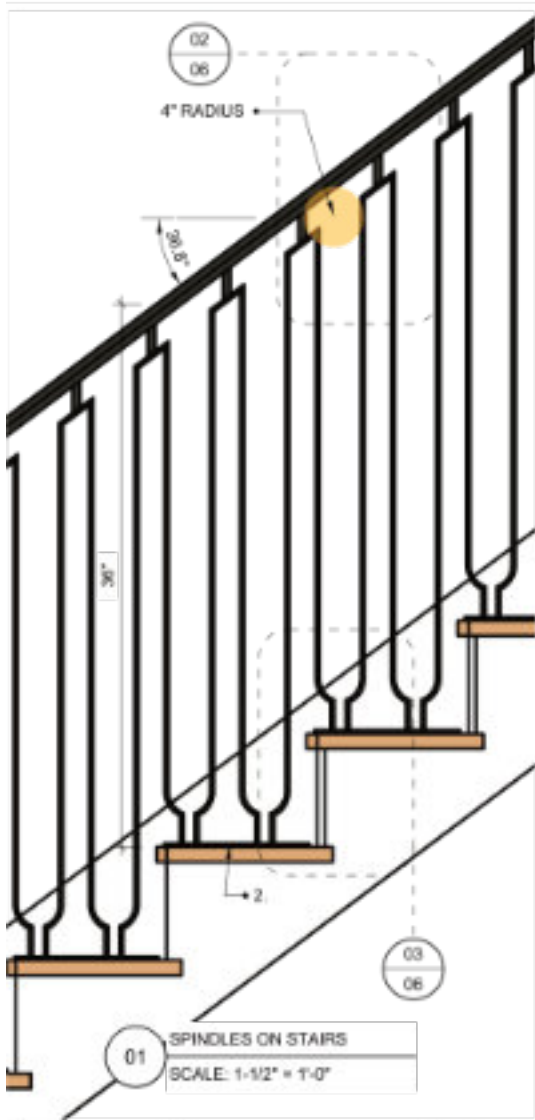

DRAWING NOTES

1. 1/4" THICK BAR
2. MOUNTED INTO METAL PLATE

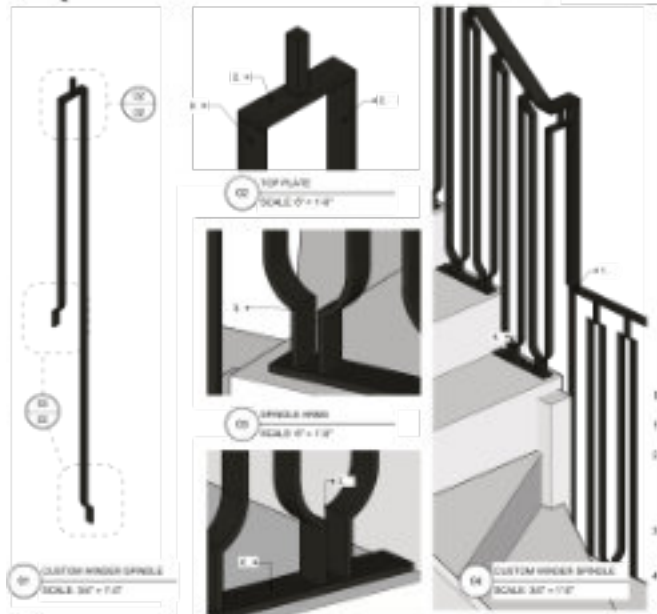

DRAWING NOTES

1. SPINDLE ARM TO EXTEND FROM 81/2" TO 9" WINDING PLATE AND SPINDLES ARM TO BE ORTHOGONAL TO EACH OTHER ON THE SAME TOP PLATE TO ALLOW 90° TRANSITION BETWEEN UPPER AND LOWER FLIGHTS
2. COMPLETE 1/2" SHAPE ON BOTH FLIGHTS WITH THE CUSTOM SPINDLE
3. BASE PLATES POSITIONED 7/8" FROM TREAD RETURN (SIDE) AND NOBING (FRONT)

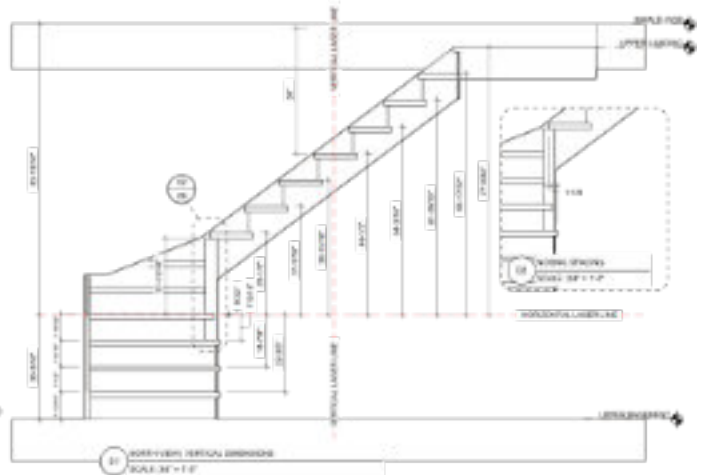

Stair Design Showcase



NEW STAIRS & RAILINGS

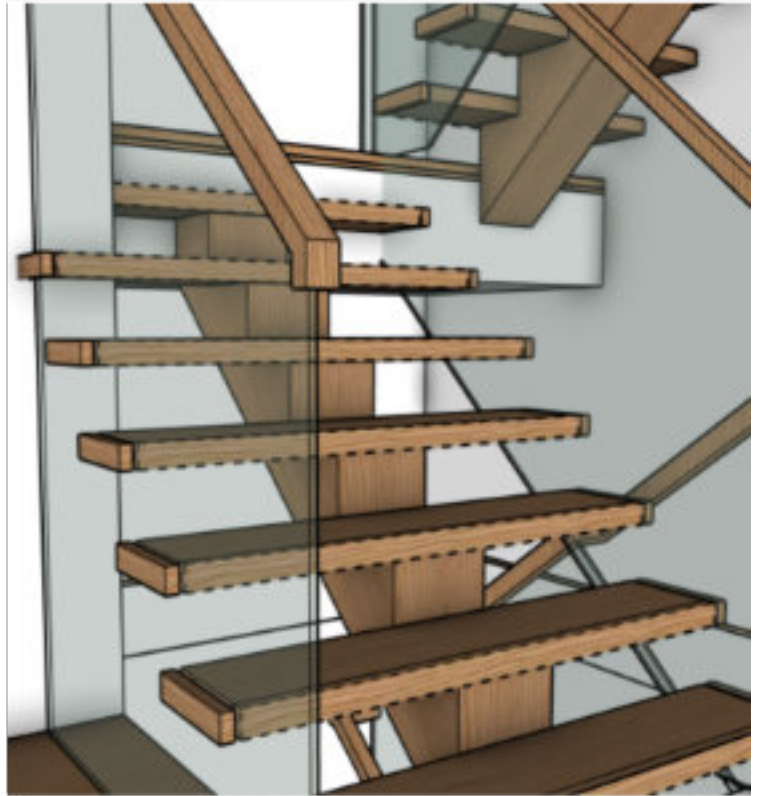

NEW RAILINGS

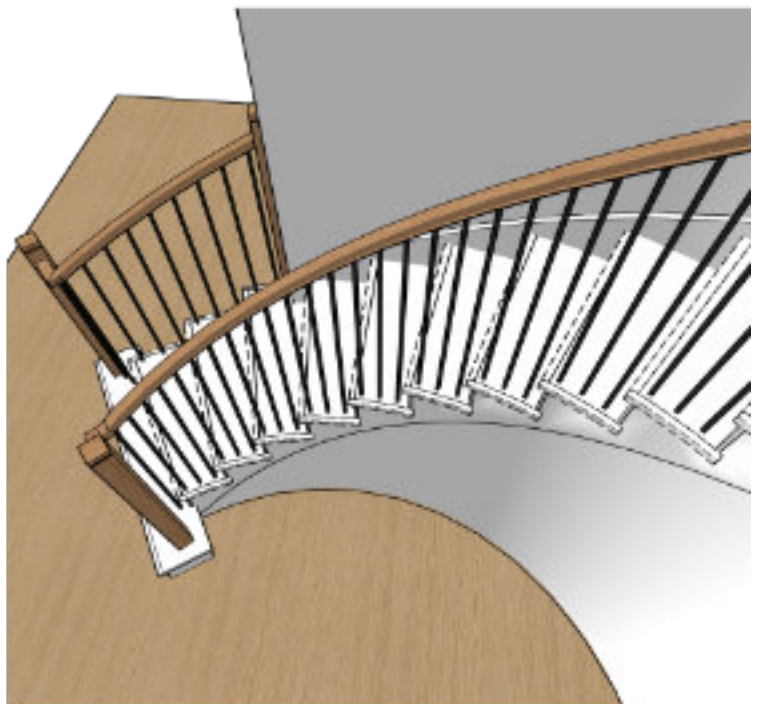

Stair Design Showcase

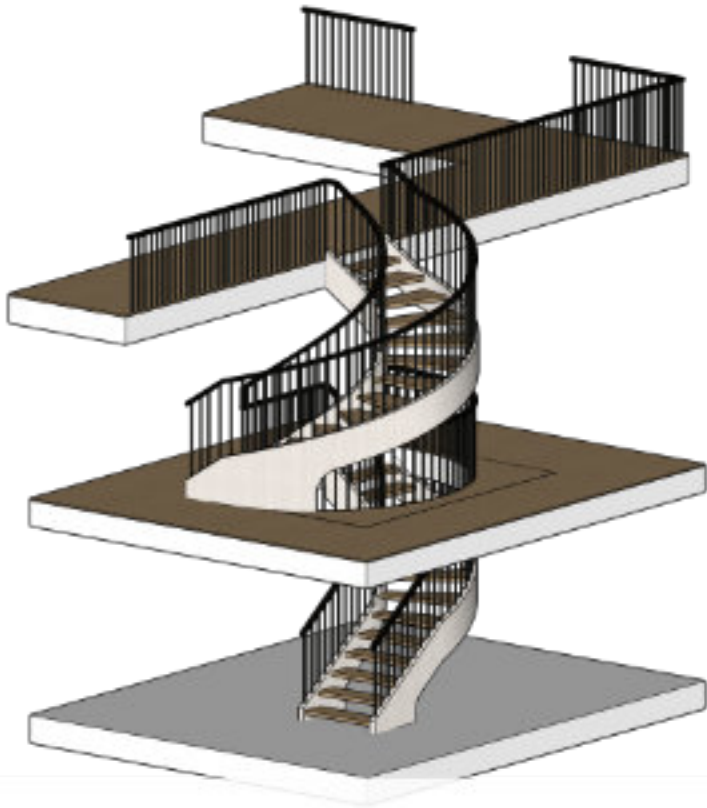

NEW STAIRS & RAILINGS



STAIR RECAP & NEW RAILINGS

Deck Design (2024)



Independent Design Residential Design

- Created renderings to help a carpenter pitch two skirting options to a homeowner
- Compared costs and benefits between both options and compiled it into one presentation package
- Prepared a material cut list for the carpenter
- Created dimensioned drawings
- Helped to secure approval and begin construction

NAME	DIMENSIONS	QUANTITY
BEAMS	2" X 10" X 10'-0"	8 PIECES
JOISTS	2" X 10" X 5'-4"	8 PIECES
	2" X 10" X 12'-0"	10 PIECES
CONCRETE FOOTINGS	10" X 10" (BASE)	8 PIECES
FOOTING POSTS	4" X 4"	8 PIECES
TOP RAIL	2" X 6"	63 LF
BOTTOM RAIL	2" X 4"	60 LF
SPINDLES	1.5W" X 1.1W"	147 PIECES
RAILING POSTS	4" X 4"	11 PIECES
DECK BOARDS	-	216 SQUARE FEET
SKIRTING: DECK BOARDS	3'-3" X 55'-5"	182 SQUARE FEET
SKIRTING: LATTICE	3'-3" X 55'-3"	182 SQUARE FEET

Deck Design (2024)

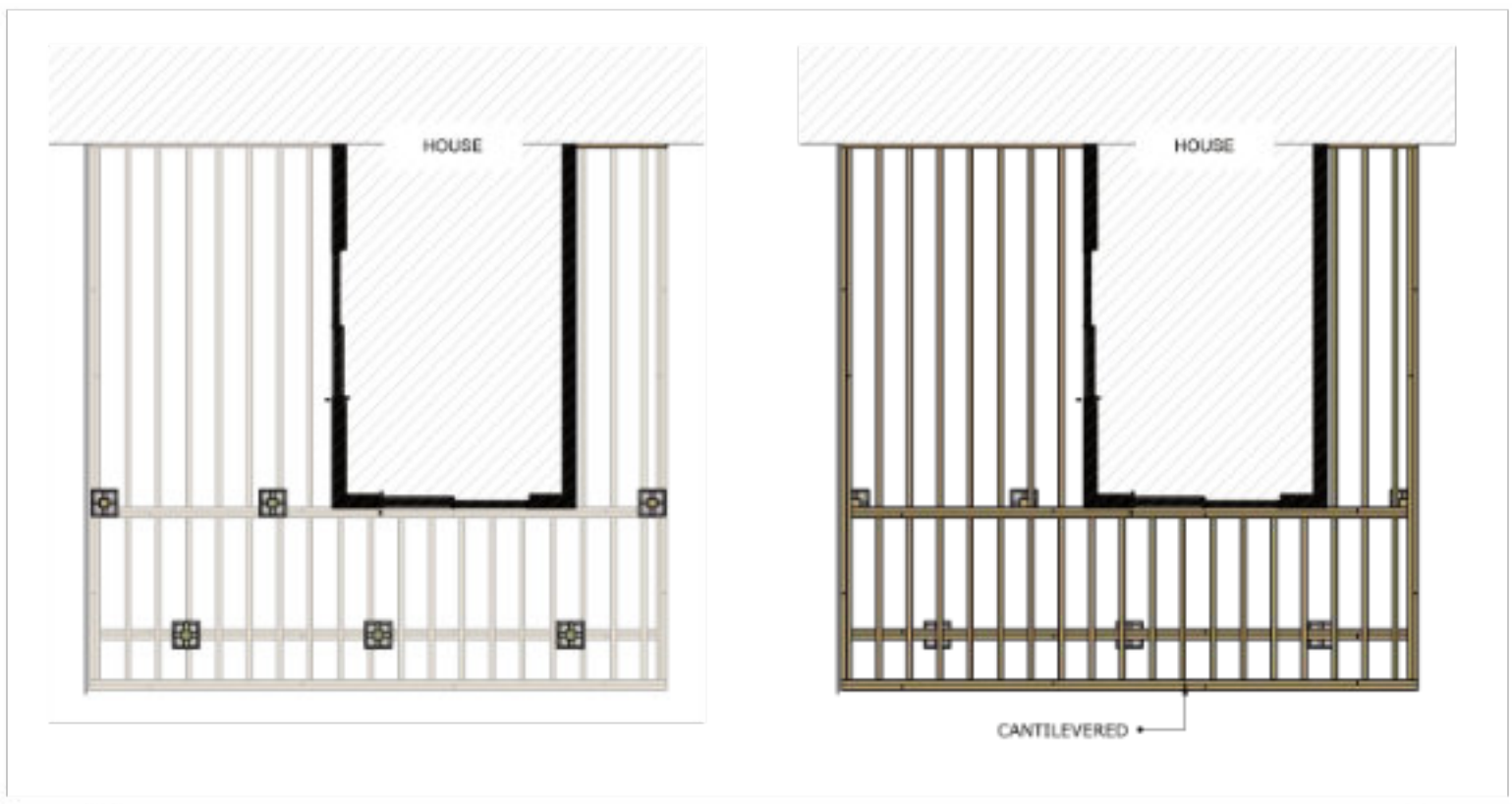

Deck Design (2024)



Deck Design (2024)

Deck Design (2024)



Leone's K9-5: Doggy Daycare

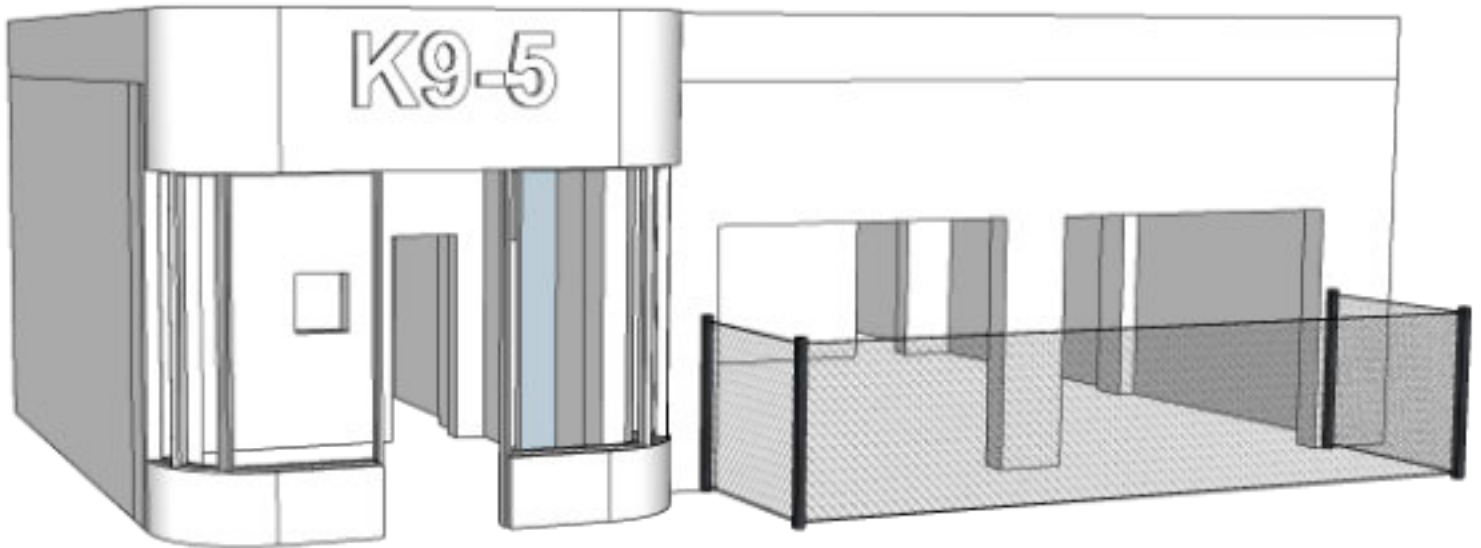

Independent Design Commercial/Hospitality Design

- Converted an auto-repair shop into a dog daycare
- Designed the space for 5-12 small to mid-sized dogs
- Created an open, bright, and playful environment
- Planned for independent owner operations

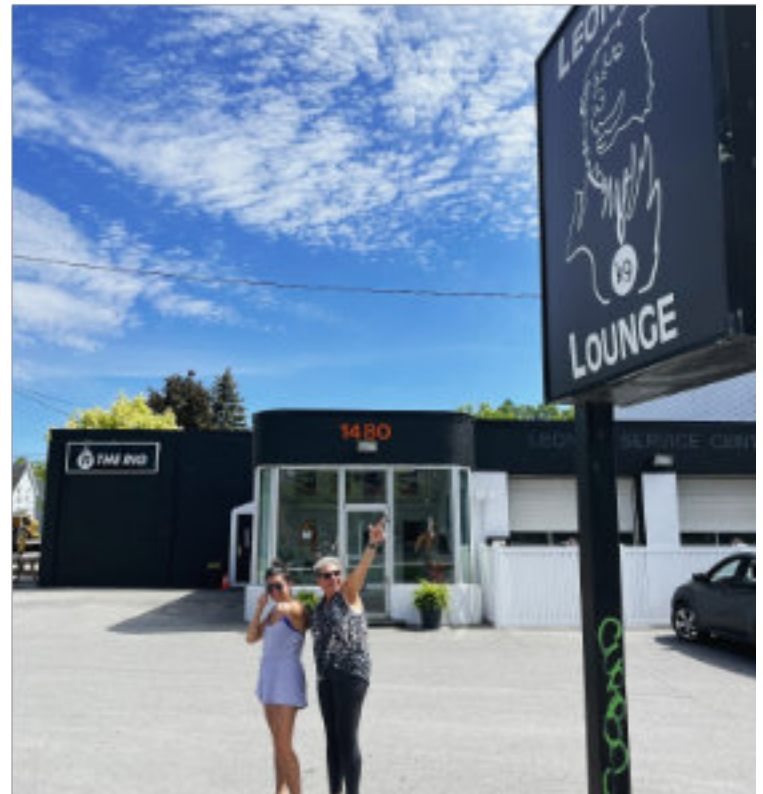

Leone's K9-5: Doggy Daycare

Leone's K9-5: Doggy Daycare

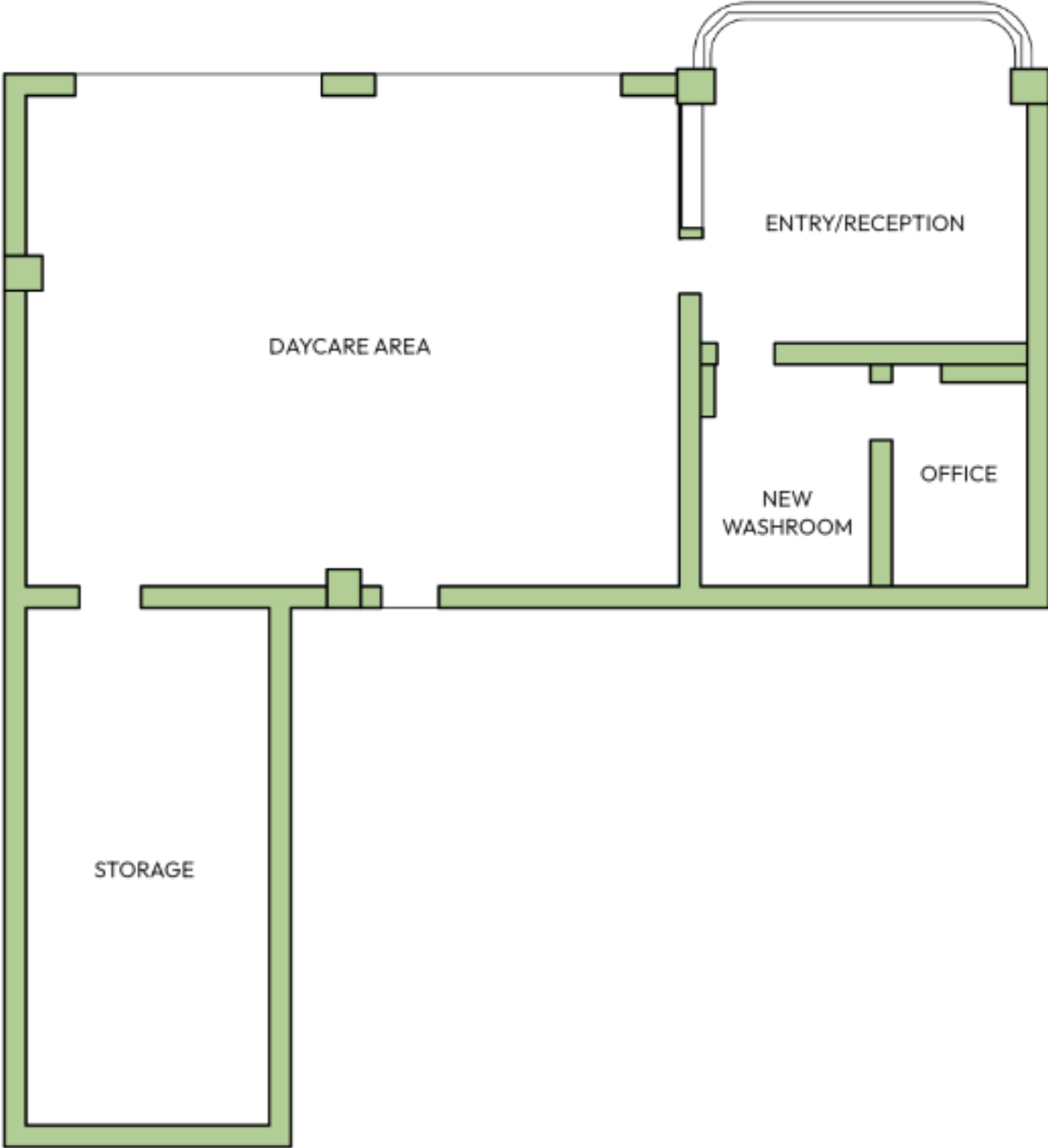

Leone's K9-5: Doggy Daycare

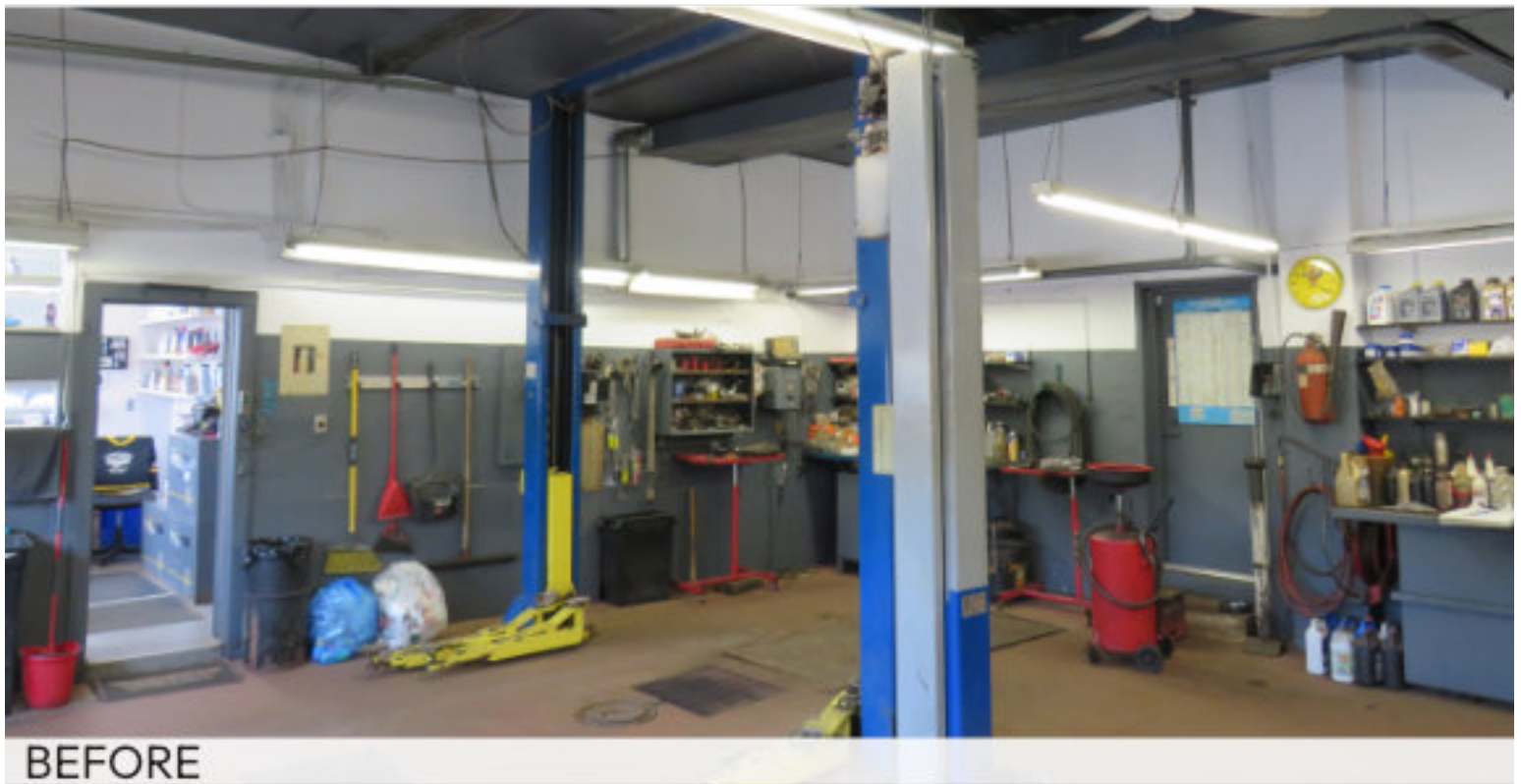
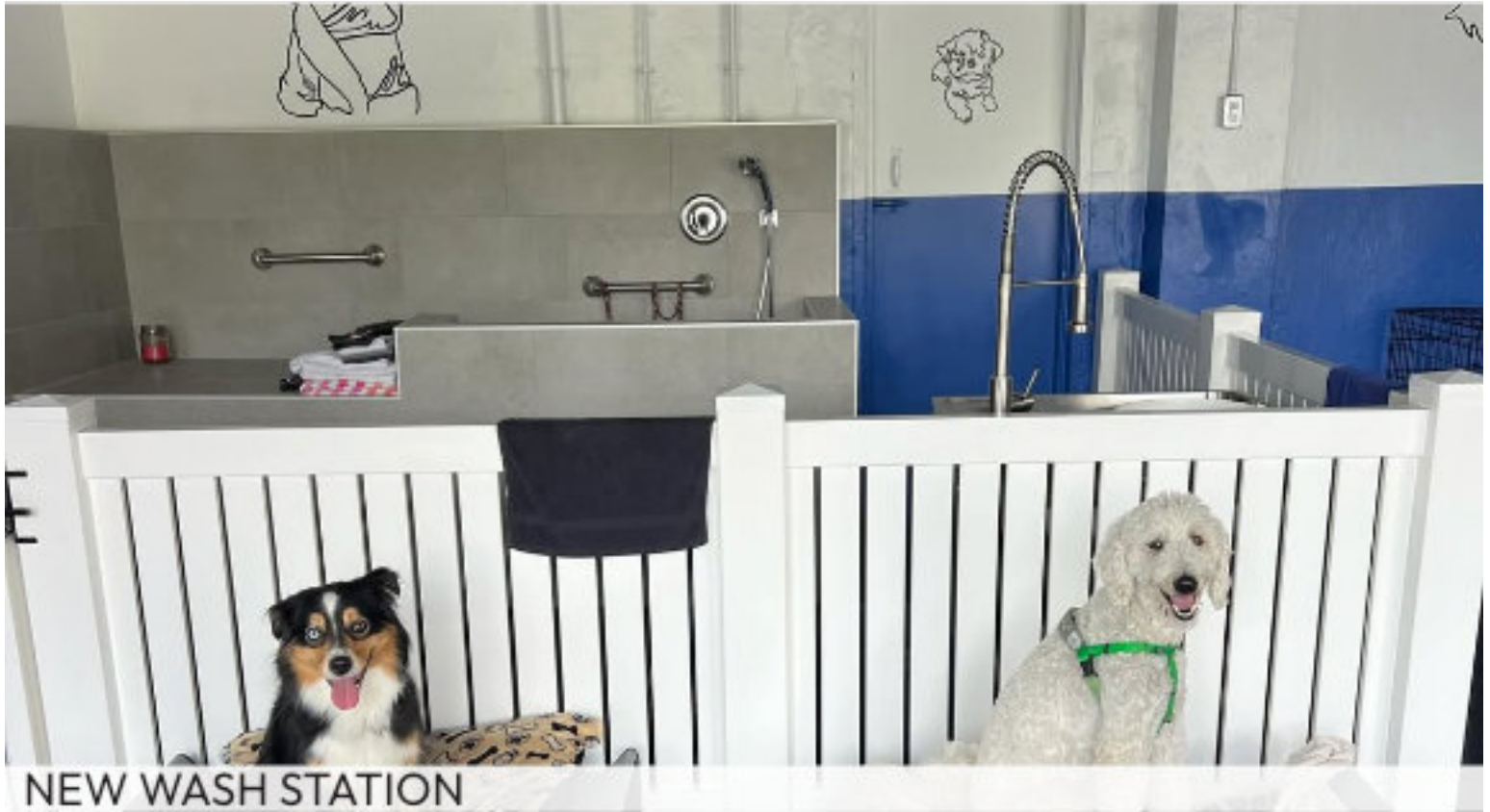

Leone's K9-5: Doggy Daycare

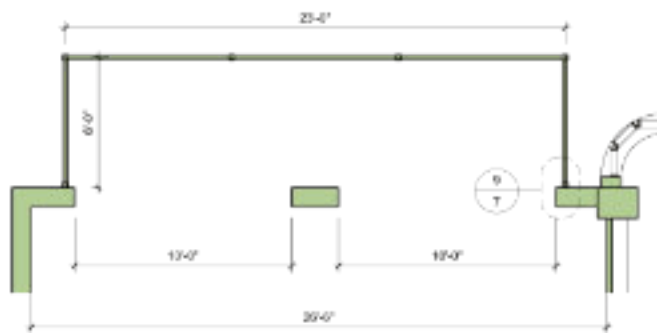
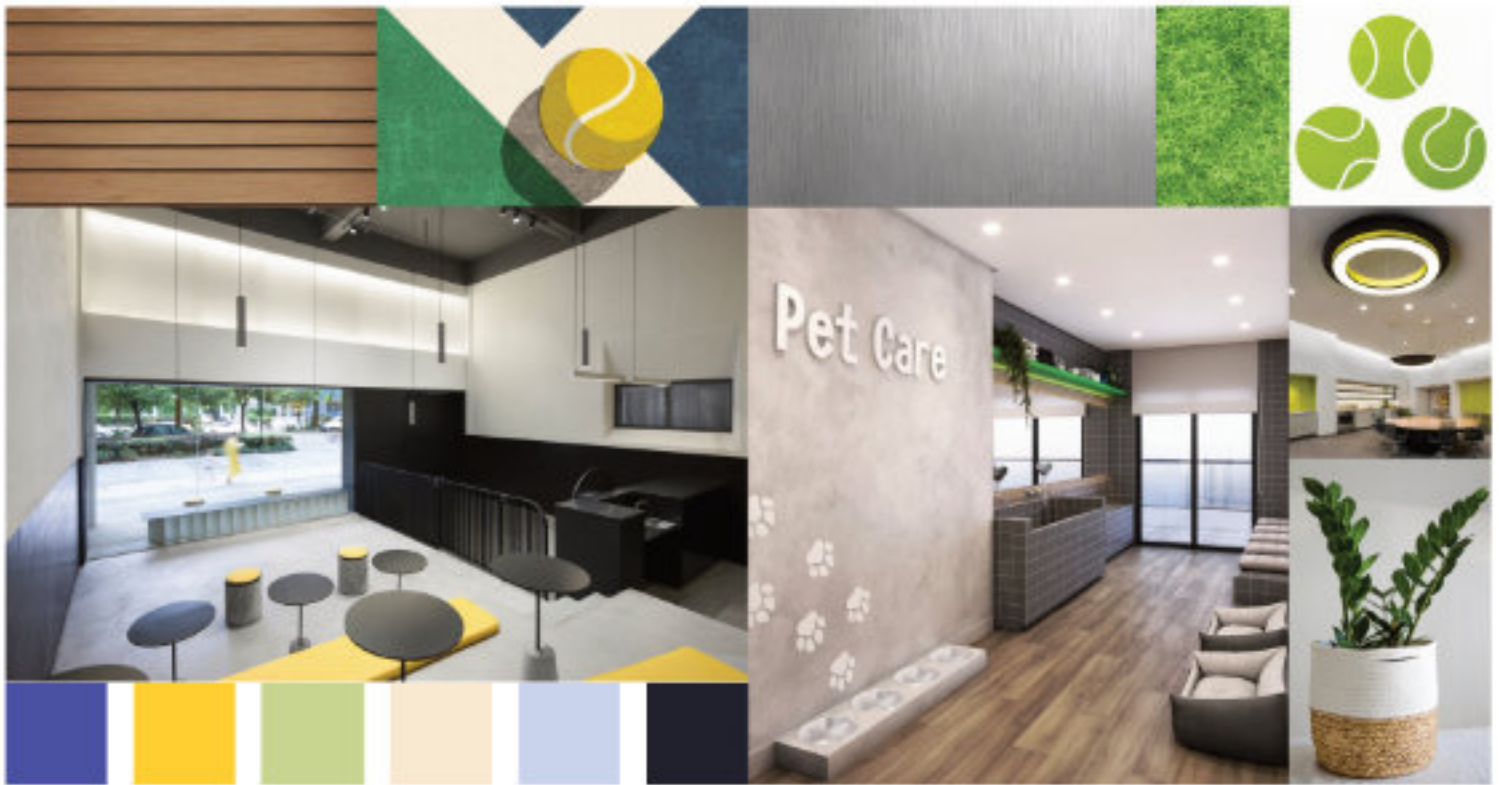

B GARAGE DOOR + FENCE DETAIL
SCALE: 1/4" = 1'-0"

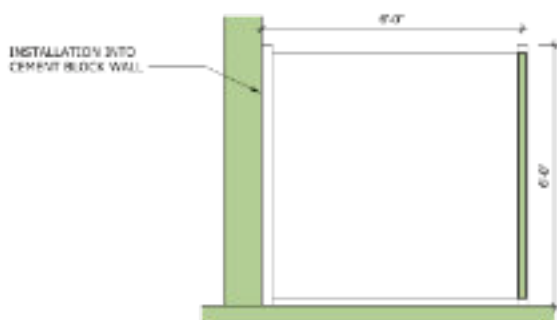

INSTALLATION INTO
CEMENT BLOCK WALL

D FENCE DETAIL
SCALE: 1/2" = 1'-0"

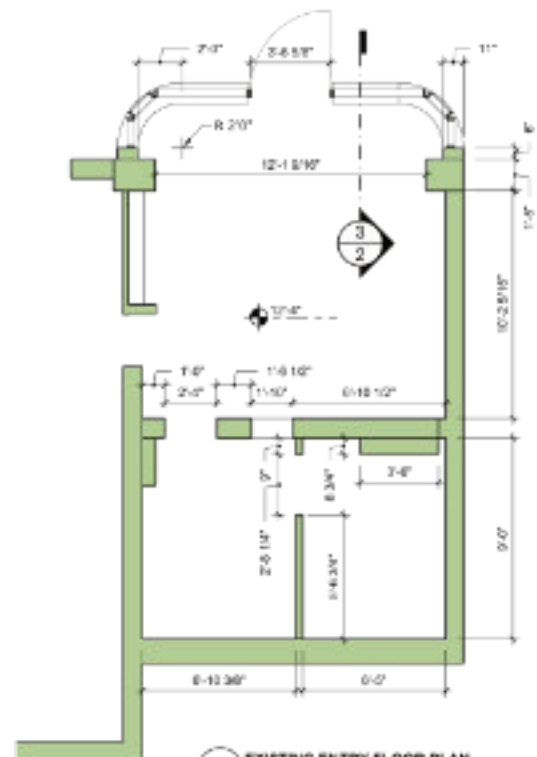

2 EXISTING ENTRY FLOOR PLAN
SCALE: 1/4" = 1'-0"

Deck Design (2023)



Independent Design Residential Design

- Developed conceptual designs for a deck renovation
- Created bubble diagrams to define activity zones
- Produced renders to communicate design intent
- Conceptual works helped the client visualize their space
- Works would be used in collaboration between client and carpenter to ensure design direction is being met

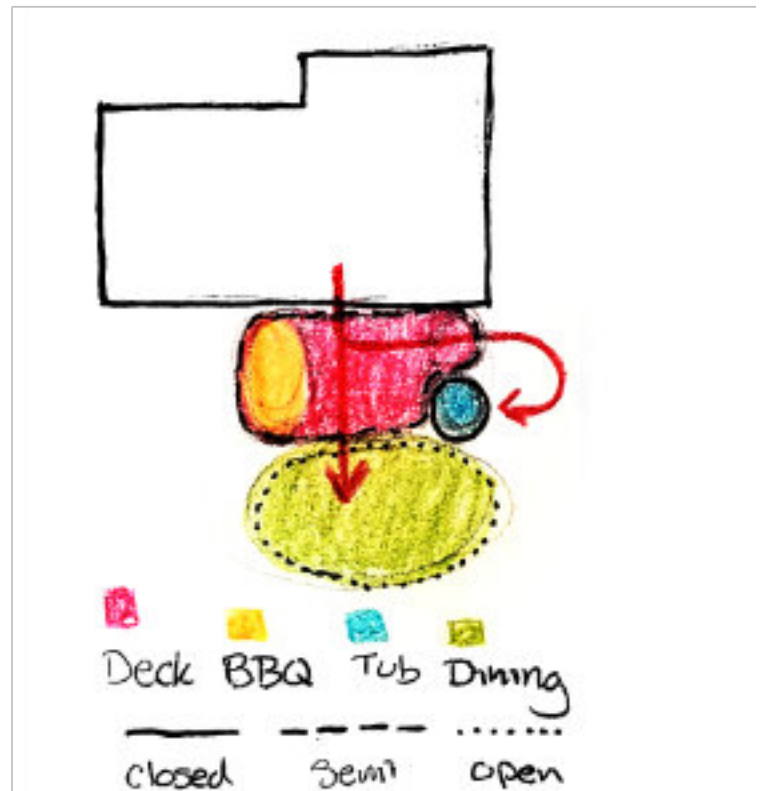

Deck Design (2023)



BEFORE



RENDER

Deck Design (2023)



BEFORE



BEFORE

Deck Design (2023)

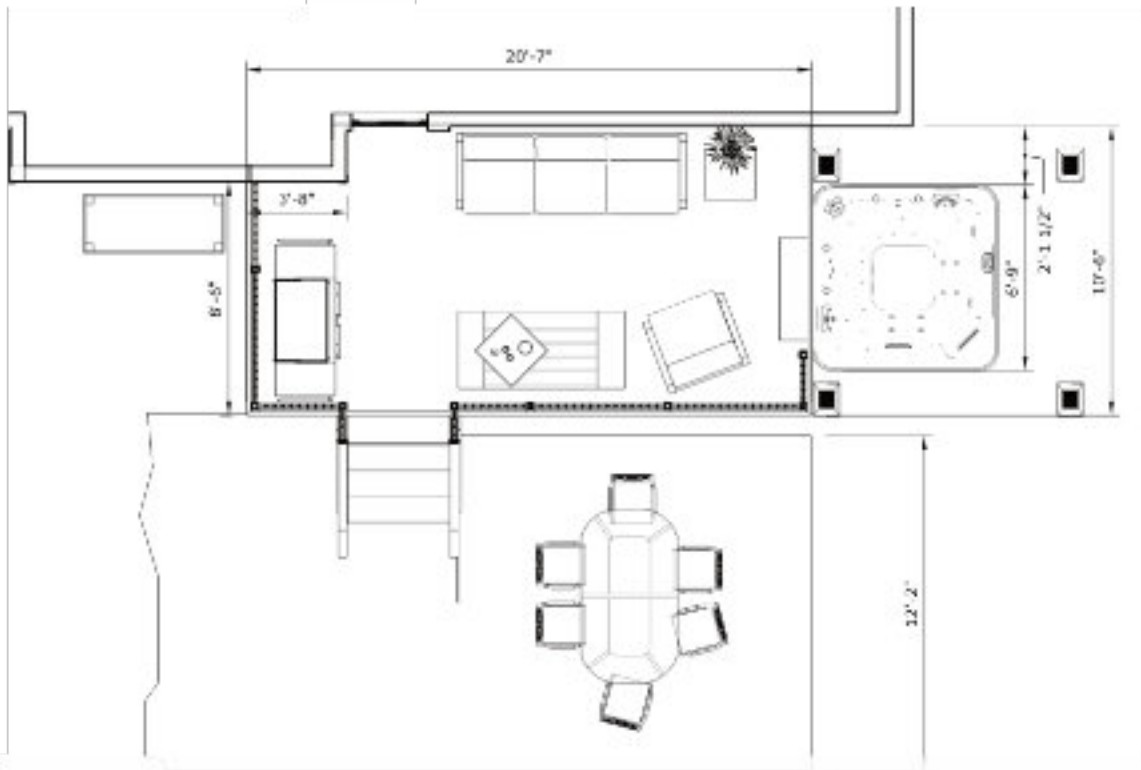

PLANS

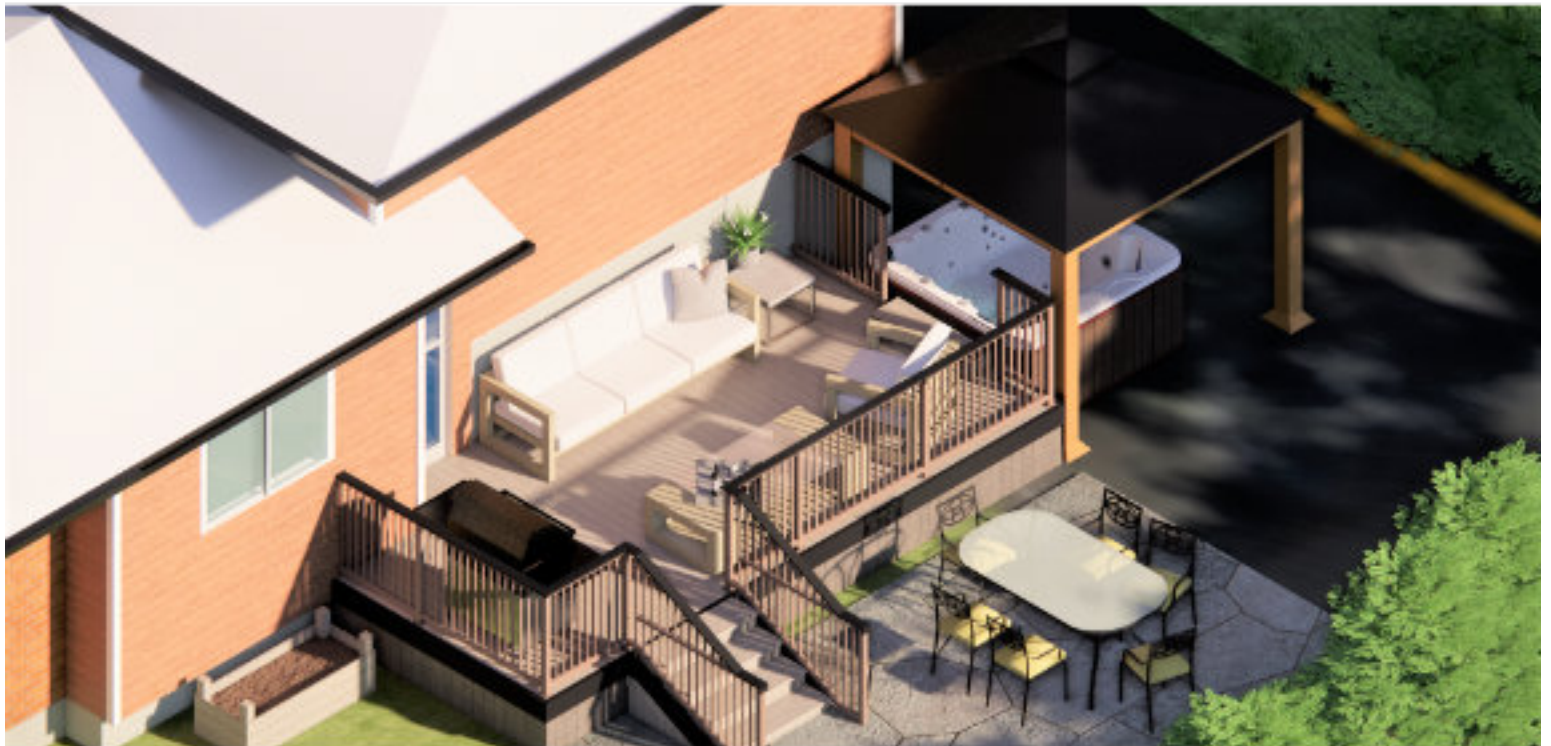

RENDER

S.T.E.A.M. Makerspace Library



EXTERIOR

BID Studio Project Institutional Design

- Designed a community-focused makerspace library
- Situated in a high-traffic, public transit accessible location
- Addressed lack of local public libraries and growing need for third spaces
- Focused on S.T.E.A.M. programming
- Created an inclusive space for people to learn, create, and grow through play, experimentation, and collaboration



Central public transit
Population: 244,654



Central commercial plaza in
the core of Barrhaven.

Only one public library in Barrhaven



Family-oriented community
Households with children: 50%



Median Age: 39 Years
Average Household Income:
\$134,657

S.T.E.A.M. Makerspace Library



ENTRY & RECEPTION



S.T.E.A.M. Makerspace Library



COLLECTION

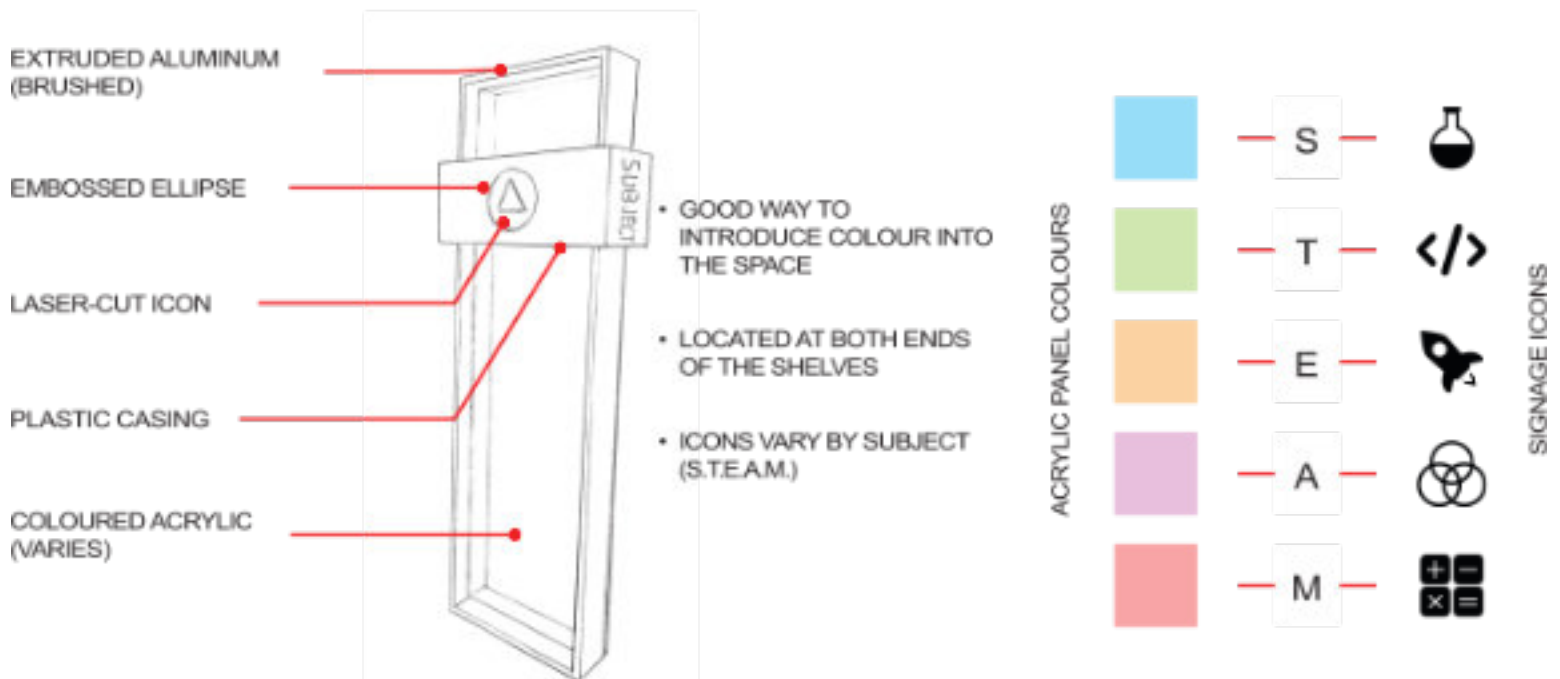

SIGNAGE DETAILS

S.T.E.A.M. Makerspace Library



MEZZANINE | MAKERSPACE

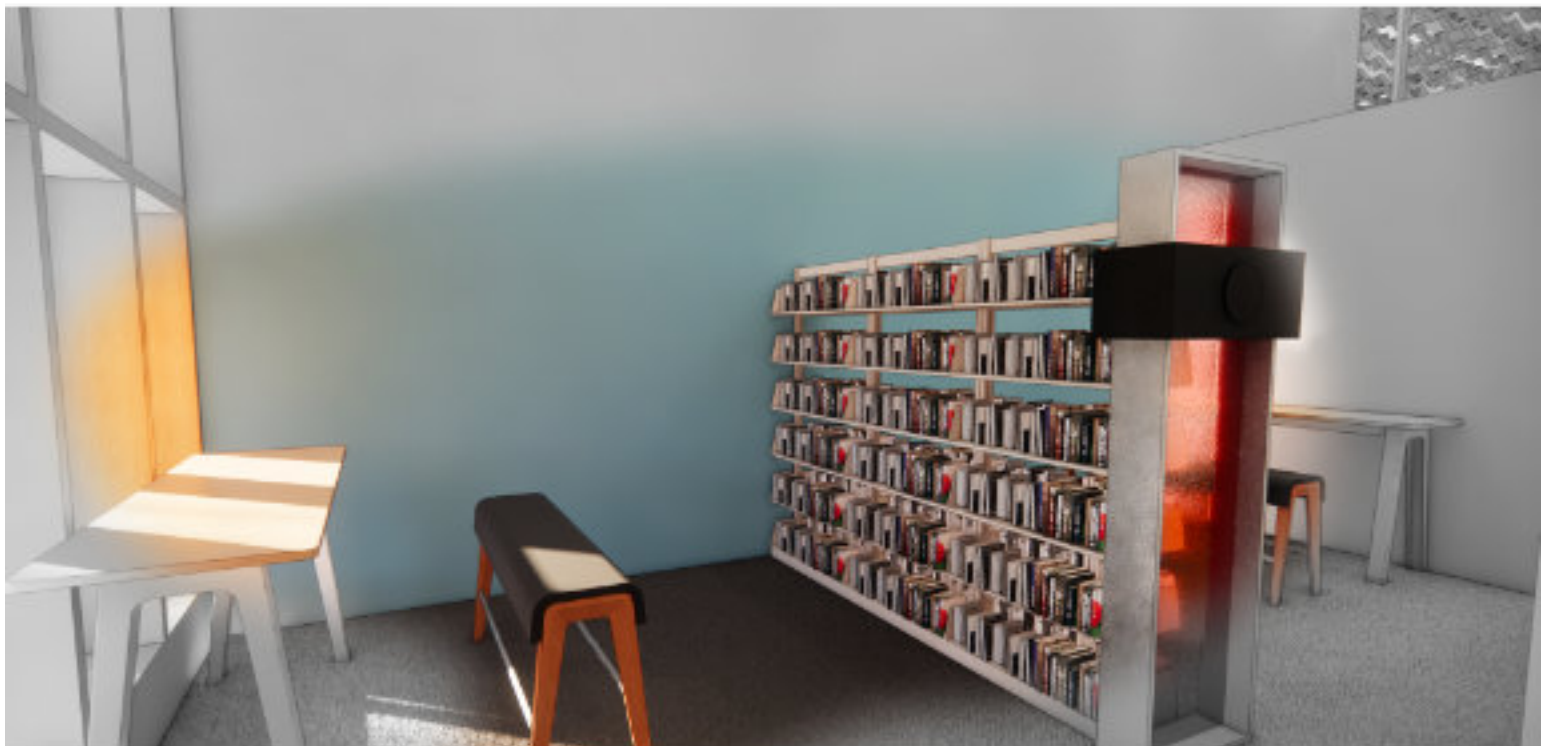

SEATING AREA

Provecho



MITSUHARU TSUMURA



"ITS TIME TO
DEMOCRATISE DELICIOUS"

Nikkei - Peruvian Cuisine
Japanese Gastronomy Techniques

Accessibility
Local Ingredients native to Peru

PROVECHO

PROVECHO

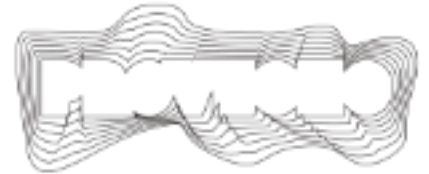

BID Studio Project Hospitality Design

- Designed a restaurant in Japan, inspired by Peru.
- A complementary brand to "Maido."
- Used mountains, rivers, and topography motifs as inspiration and guiding point for the concept.
- Integrated the concept through layouts, lighting, materials, texture, and colour.



Provecho

LEGEND

1. PALLAS TEXTILES - SWAY
2. ACUTEX - CUBE - BEEHIVE
3. NEOLITH - BASALT BLACK - SATIN
4. PLATFORM SURFACES - MATTONE - PINK PANTHER
5. PORCELANOSA - ASTON CLASSICO
6. FORMICA DECOMETAL - NATURAL GOLDTONE ALUMINUM
7. FORMICA - BUFFED NICKEL
8. FORMICA - BRUSHED ALUMINUM BLACK
9. FORMICAL CHALD SOLIDZ
10. CUSTOM 3D PRINTED TILES - TOPOGRAPHIC
11. LUMICOR - SILVER SPUN
12. LAMINATE - WOOD PANEL - THIN STRIPS
13. 3FORM - TONIC - CLEAR
14. GOODWIN COMPANY - RIVER-RECOVERED HEART PINE - CURLY



Provecho



SECOND FLOOR



GROUP SEATING

Provecho

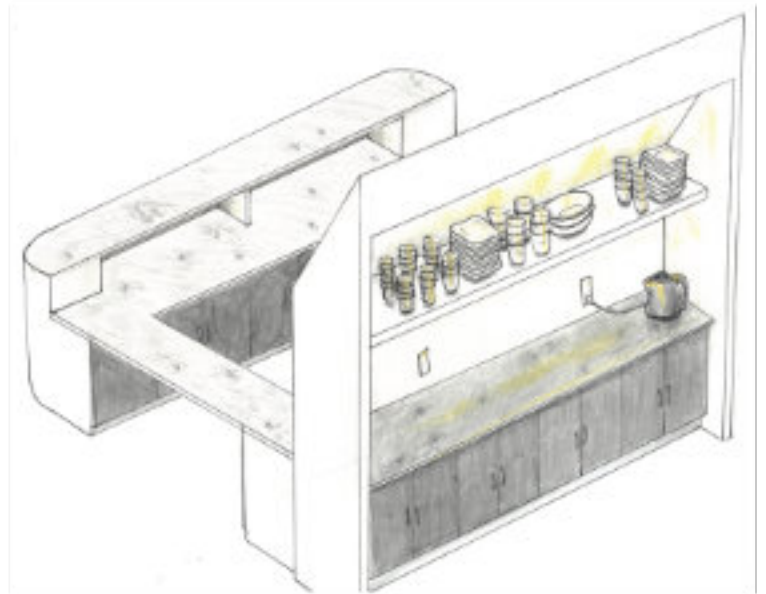
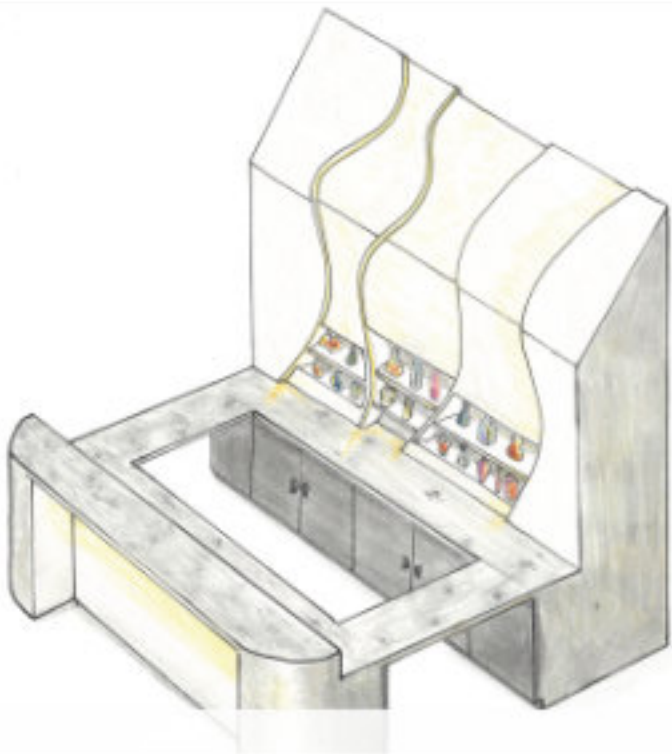

CUSTOM BAR/SERVICE

Deck Design (2022)



Entrepreneurship Co-op Residential Design

- There was an opportunity to connect with a client who wanted to replace their temporary outdoor setup with a permanent, long-term solution.
- 3D renders, material selections, and plans were created for the client as a reference and guide during the construction of the space.
- An initial interview was conducted with the client to identify requirements and concerns. The existing condition of the site was documented and the measurements were used to create the working model.
- Vendors of outdoor structures were contacted to research and learn about possible solutions. Once a vendor was selected, they were invited out to site to talk with the client.



Deck Design (2022)

FINDINGS AFTER MEETING WITH SUNCOAST SALES REPRESENTATIVE

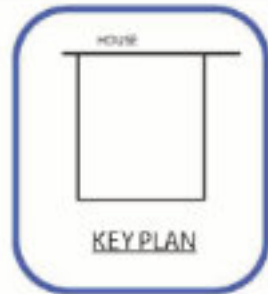

ROOF TYPES



FINANCING

25% AT THE START OF CONTRACT
50% AT THE START OF CONSTRUCTION
25% ONCE COMPLETE

CURRENT DELIVERY TIME (LEAD-TIME)
AROUND NOVEMBER

IF WINDOWS ARE SPECIFIED - THEY ARE MEASURED ON-SITE AFTER FRAMING IS COMPLETE
TYP: 1-3 WEEKS OF MANUFACTURING DEPENDING ON SPECIFICATIONS

SCREEN OPACITIES: 3

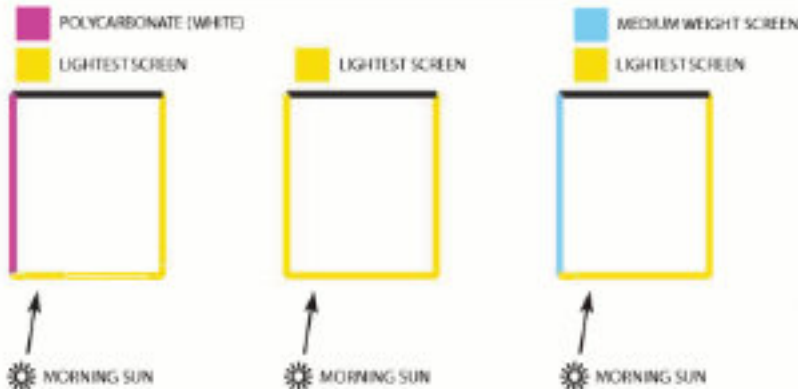

POLYCARBONATE PANELS



CAN BE USED ON ROOFS OR WALLS

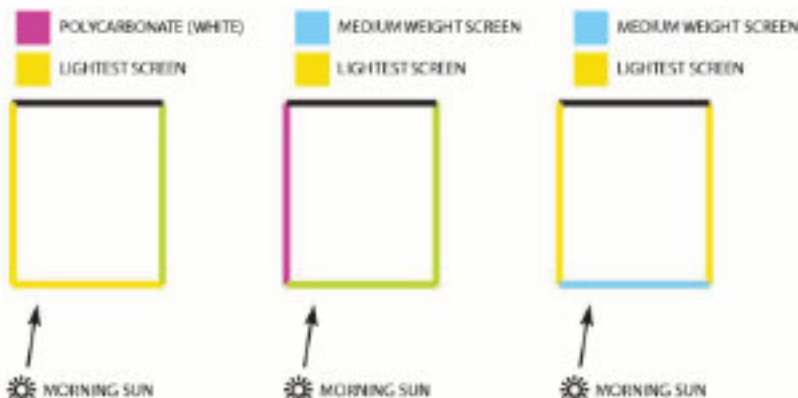

RETRACTABLE SCREENS

AVAILABLE IN SCREENING OPTIONS LISTED

2 HOUSINGS

5.5" - UP TO 22' WIDE AND 11' DROP

7.5" - UP TO 30' WIDE AND 22' DROP

BOTTOM BAR OPTIONS

STANDARD VS. RECESSED TRACK

REMOTE CONTROLLED & SMART HOME COMPATIBLE

3 SEASON WINDOWS

WITH MEMORY FLEX VINYL GLAZING
OR SCREEN FINISH

Deck Design (2022)



Deck Design (2022)

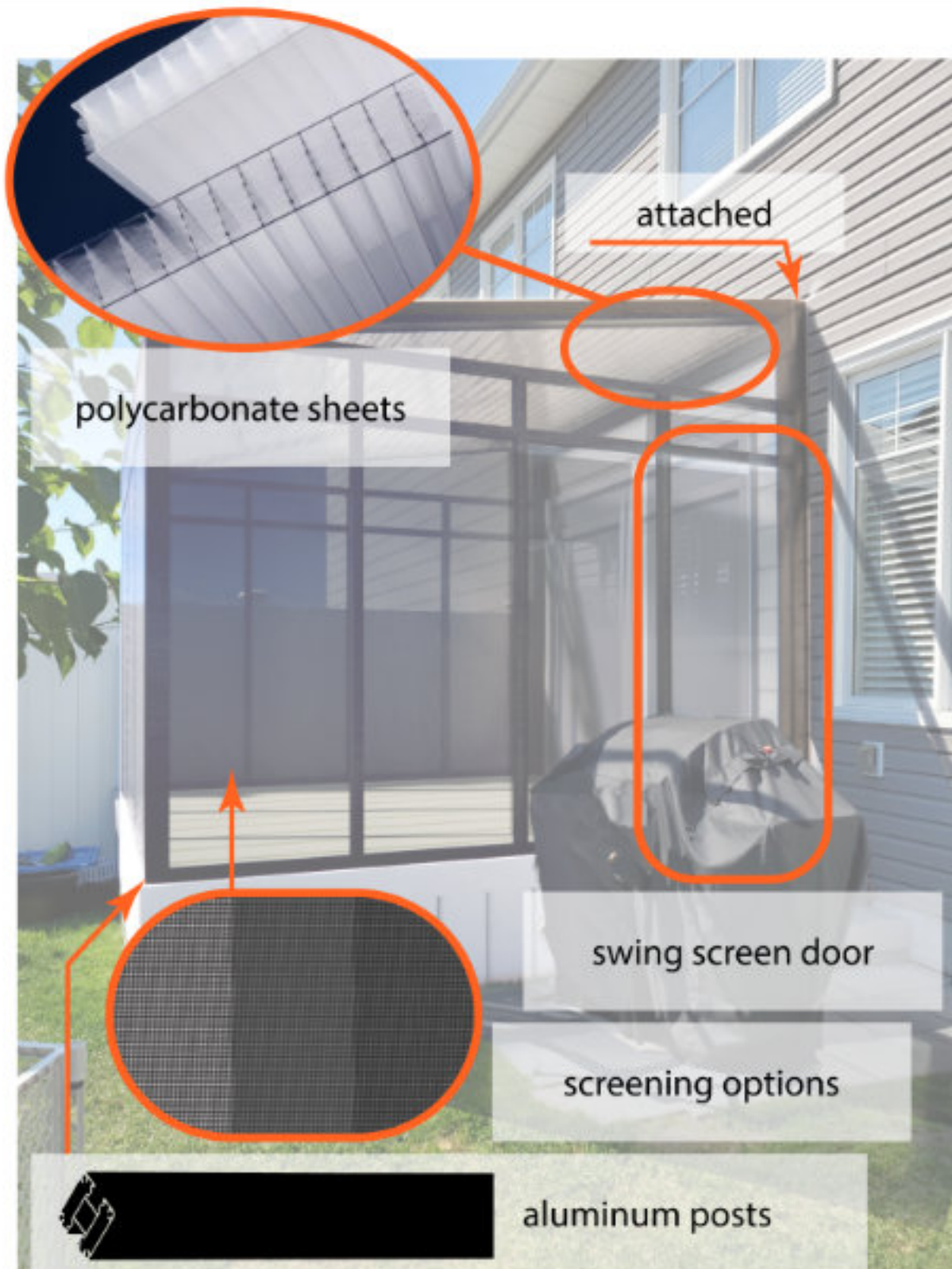

Cultural Association for Healthy Minds



BID Studio Project Healthcare Design

- Designed a multi-storey mental health facility focused on supporting immigrant youth, addressing cultural stigma and barriers to accessing care.
- Collaborated in a team, using a cloud-based Revit model, coordinating plans, layouts, developments, and documentations within a shared BIM workflow
- The space is designed to connect individuals and create community between clients and staff.
- Space requirements were defined by the needs and activities of the identified users of the service
- Created social and communal zones to encourage peer support while maintaining privacy in clinical areas through thoughtful zoning and adjacencies.



Cultural Association for Healthy Minds



STACKED AXO

Cultural Association for Healthy Minds

Cultural Association for Healthy Minds



1ST FLOOR: RECEPTION

Cultural Association for Healthy Minds

Cultural Association for Healthy Minds

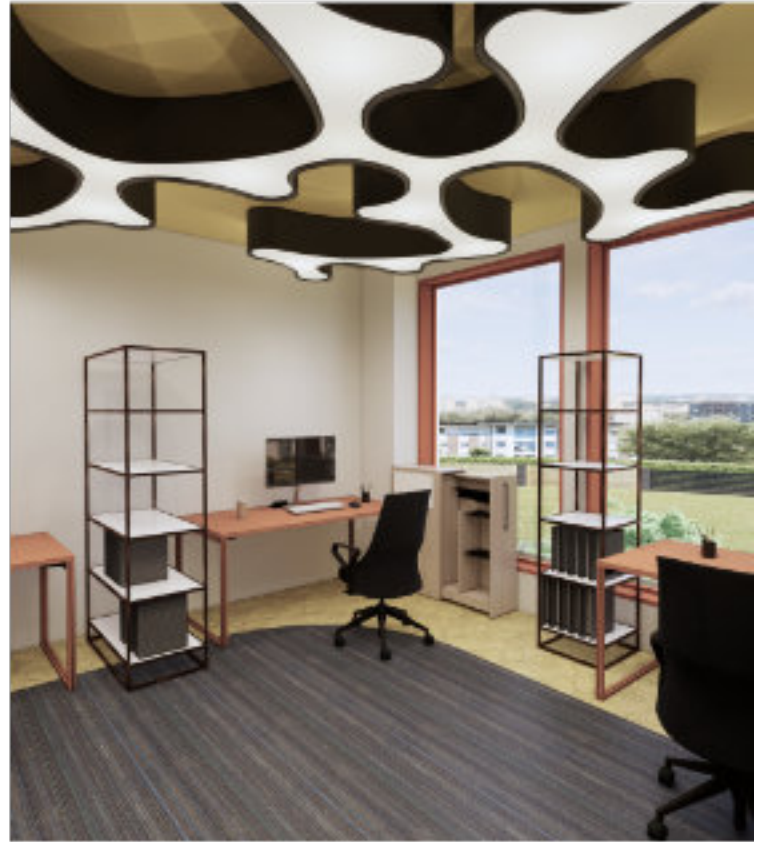
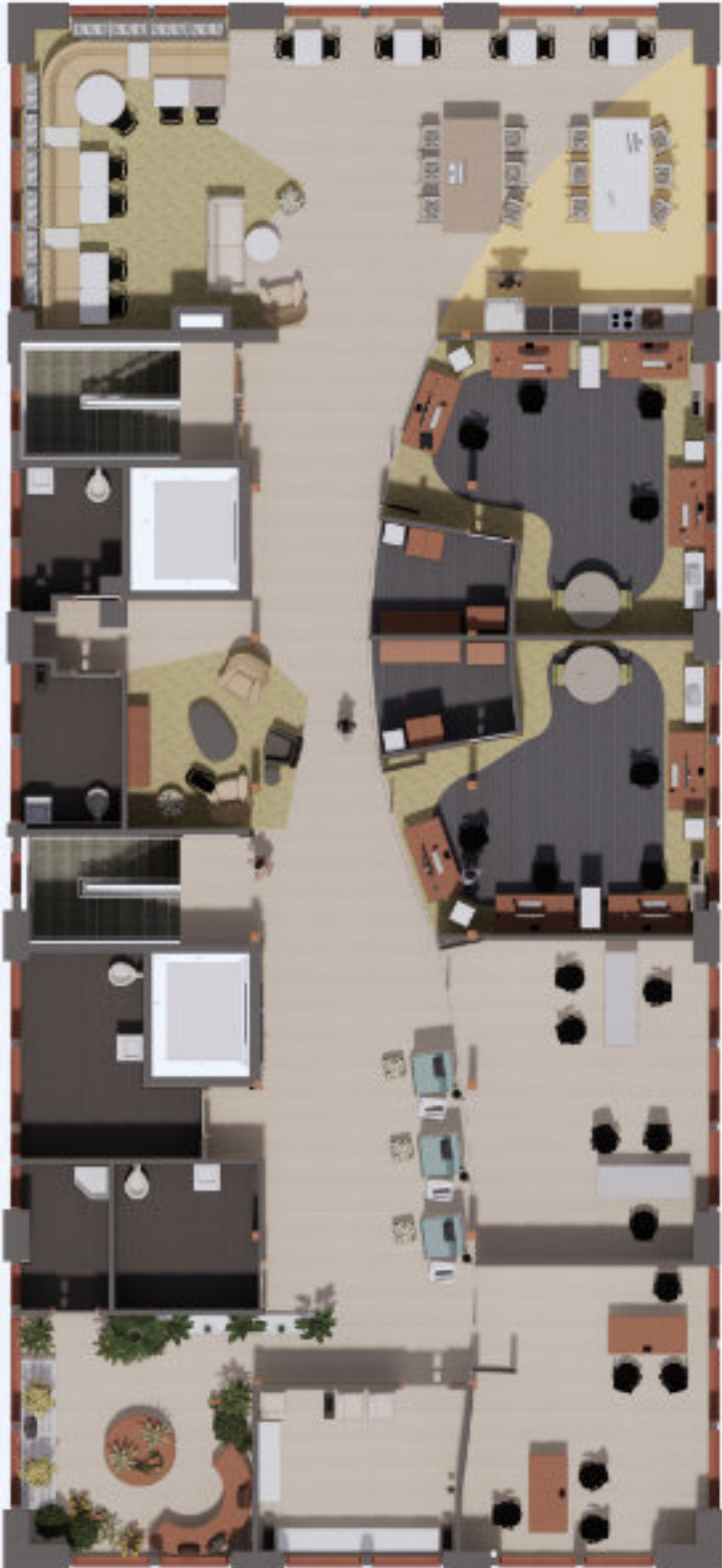

5TH FLOOR: ADMINISTRATION

Cultural Association for Healthy Minds

Cuppedia



BID Studio Project Commercial/ Residential Design

- Cuppedia: The Coffee Encyclopedia. Where the art of coffee meets expertise.
- This mixed-use project features a coffee shop and bakery on the ground floor and two residential units on the second floor. The owners of the larger unit also run the coffee shop. These spaces were the project's focus.
- The design challenge was to clearly identify and separate public vs private space while maintaining optimal flow and function within the space.



Cuppedia

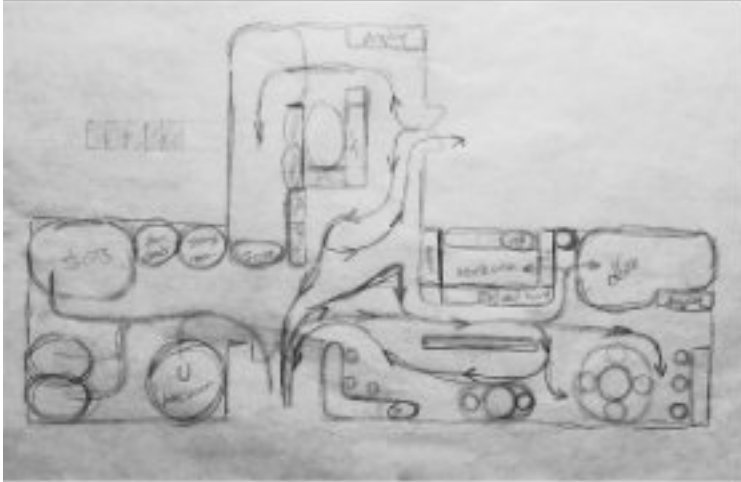

CONCEPT DEVELOPMENT & "JUNK" MODELS

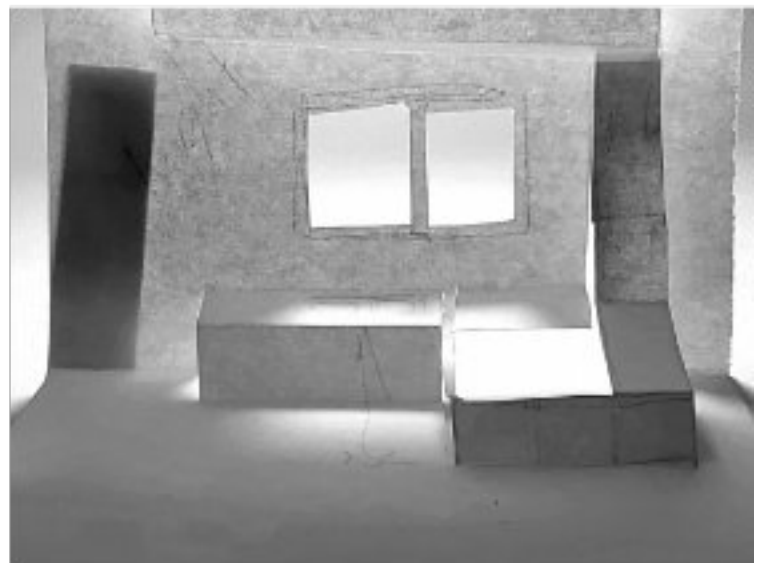
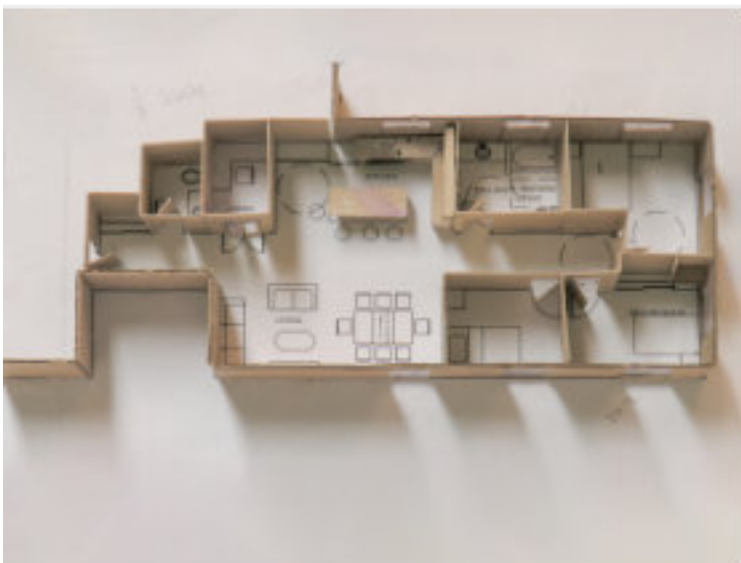

Cuppedia

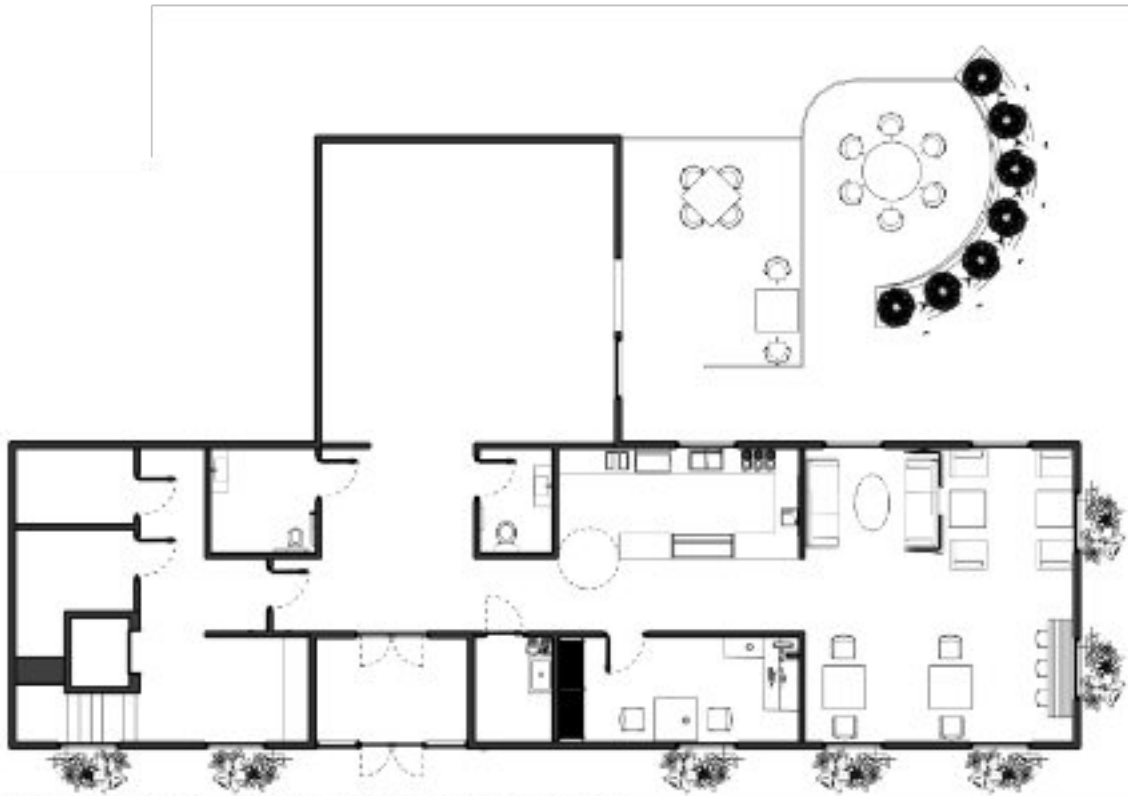

GROUND FLOOR PLAN (COMMERCIAL)



SECOND FLOOR PLAN (RESIDENTIAL)

Cuppedia



SEATING AREA (COMMERCIAL)



SHARED LAUNDRY (RESIDENTIAL)



OFFICE (RESIDENTIAL)